

Thank you for purchasing this Dynojet kit. This kit has been developed for a motorcycle which is set to the parameters listed at the right in the “Stage” description. If your motorcycle does not meet any of these parameters please check with Dynojet before installation. For technical assistance contact your Dynojet distributor or call Dynojet U.S.A. (800)-992-4993

2191 Mendenhall Dr. Suite 105  
North Las Vegas, NV 89031  
TEL: 702-399-1423  
FAX: 702-399-1431  
8am-5pm Pacific Time  
Monday through Friday

Website Address  
<http://www.dynojet.com>

The manufacturer and seller make no warranties express or implied which extend beyond the description of the goods contained herein. Any description of this product is for the purpose of identifying it and shall not be deemed to create an express warranty.



1195.001

U.S Models Only

2007 Honda VT750C2 Spirit  
Stage 1 & 2

Stage 1

For mildly tuned machines using the stock airbox, with stock air filter. May also be used with a good aftermarket exhaust system.

Stage 2

For mildly tuned machines using the stock airbox with the intake snorkle completely removed and stock air filter. May also be used with a good aftermarket exhaust system.

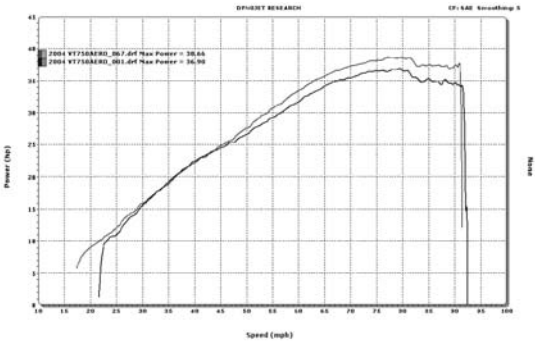

This graph shows a typical gain with a Dynojet jet kit.

# WARNING

**NO SMOKING!  
NO OPEN FLAME!  
WHILE INSTALLING  
YOUR DYNOJET KIT**

Parts List		
1	Main Jet	DJ116
1	Main Jet	DJ120
1	Main Jet	DJ124
1	Main Jet	DJ128
1	Main Jet	DJ134
1	Main Jet	DJ138
1	Main Jet	DJ142
1	Fuel Needle	DNO767
1	Adjusting Washer	DE0001
1	Slide Spring	DSP044
1	E-clip	DW0001
1	Tool	DT009

## STAGE ONE INSTRUCTIONS

1. Remove the vacuum slide from the carb. Remove the stock needle and spacers, noting the order of assembly (Fig. A).
2. Install the Dynojet needle on groove #3 from the top. Use all stock spacers (Fig. A). Install the small Dynojet washer above the e-clip. Install the Dynojet slide spring (DSP044) in place of the stock slide spring. After installing the slide in the carb, be sure to check slide movement manually before airbox installation.
3. Remove the stock main jet and replace with the Dynojet main jet provided. If you are running the stock exhaust, use the DJ120 main jet. If you are using an aftermarket exhaust\* or slip-on with a high flow baffle, use the DJ124 main jet. Be sure that the jet you are changing is the main jet.
4. Locate the fuel mixture screw (Fig. B). Using the tool provided (DT009), carefully turn the mixture screws clockwise until lightly seated, then turn back out 2.5 turns.

**\*NOTE:** If you are using an aftermarket exhaust with a baffle that has less than a 2" inner diameter, use the main jet that is called for when using the stock exhaust.

Fig. A

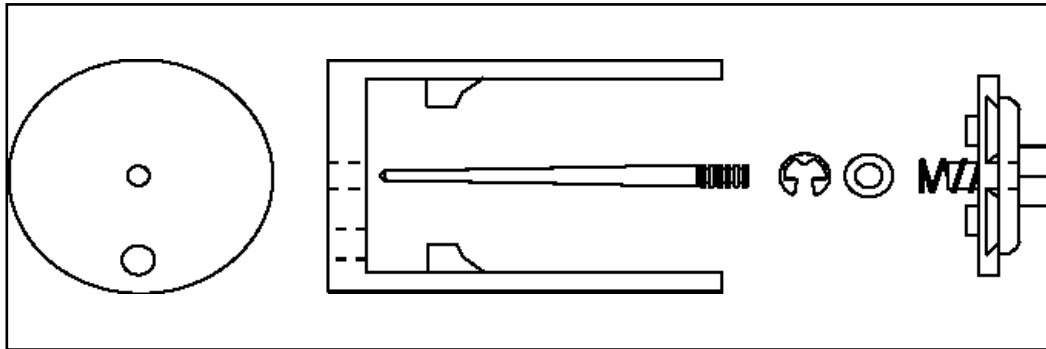

## STAGE TWO INSTRUCTIONS

1. Remove the complete intake snorkle from the airbox.
2. Remove the vacuum slide from the carb. Remove the stock needle and spacers, noting the order of assembly (Fig. A).
3. Install the Dynojet needle on groove #3 from the top. Use all stock spacers (Fig. A). Install the small Dynojet washer above the e-clip. Install the Dynojet slide spring (DSP044) in place of the stock slide spring. After installing the slide in the carb, be sure to check slide movement manually before airbox installation.
4. Remove the stock main jet and replace with the Dynojet main jet provided. If you are running the stock exhaust, use the DJ134 main jet. If you are using an aftermarket exhaust\* or slip-on with a high flow baffle, use the DJ138 main jet. Be sure that the jet you are changing is the main jet.
5. Locate the fuel mixture screw (Fig. B). Using the tool provided (DT009), carefully turn the mixture screws clockwise until lightly seated, then turn back out 2.5 turns.

**Dynojet**

1195.001

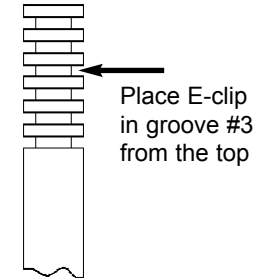

Fig. B

