

# [POWER] [COMMANDER III]

CERTIFIED **USB**

## 2004-2006 Honda FSC600 Installation Instructions

### Parts List

- 1 Power Commander
- 1 USB Cable
- 1 CD-ROM
- 1 Installation Guide
- 1 Power Adapter
- 2 Power Commander Decals
- 2 Dynojet Decals
- 2 Velcro® Strip
- 1 Alcohol Swab

Button Adjustment Display



Faceplate Buttons

Expansion Port

USB Port



**The ignition MUST be turned OFF before installation!**

You can also download the Power Commander software and latest maps from our web site at:

[www.powercommander.com](http://www.powercommander.com)

**PLEASE READ ALL DIRECTIONS BEFORE STARTING INSTALLATION**

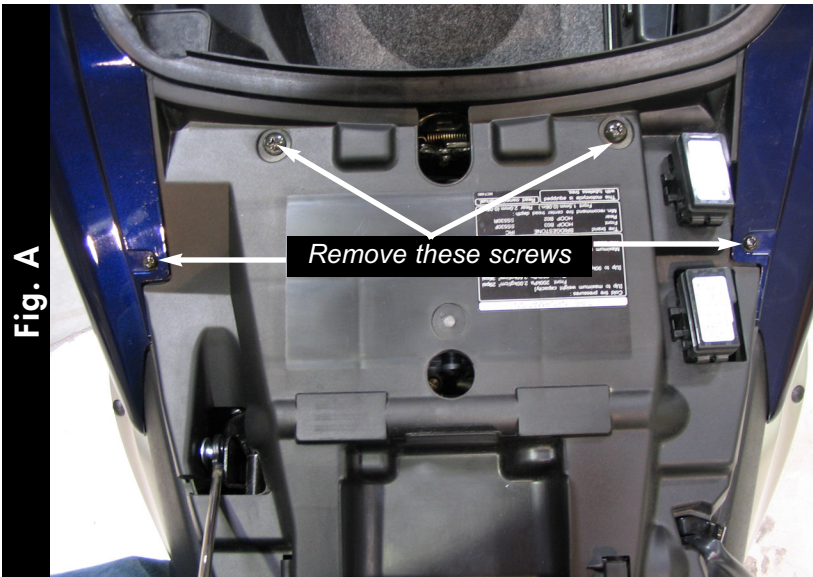

1 Remove the seat.

*It is best to completely remove the seat from the bike although the install can be performed with the seat in the up position.*

2 Remove the 4 screws that hold the engine cover in place (Fig.A).

3 Remove the engine cover.

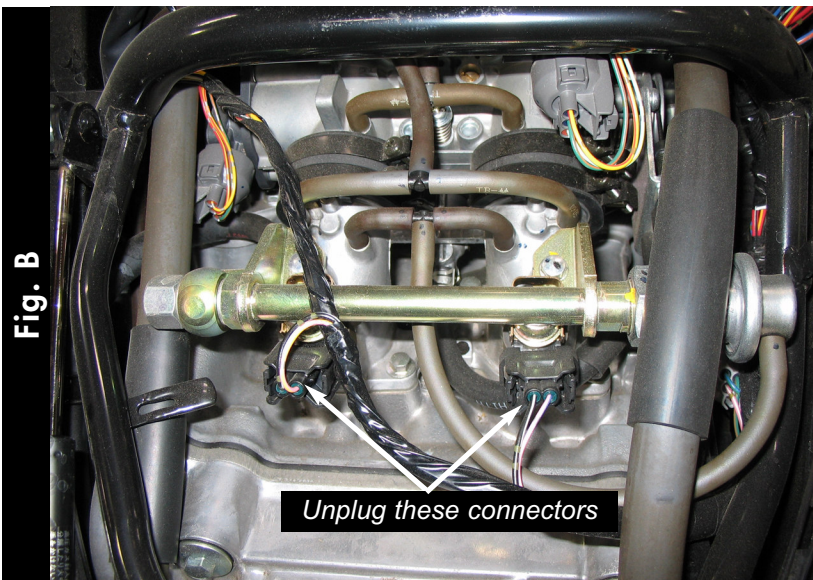

4 Unplug the stock wiring harness from each injector (Fig.B).

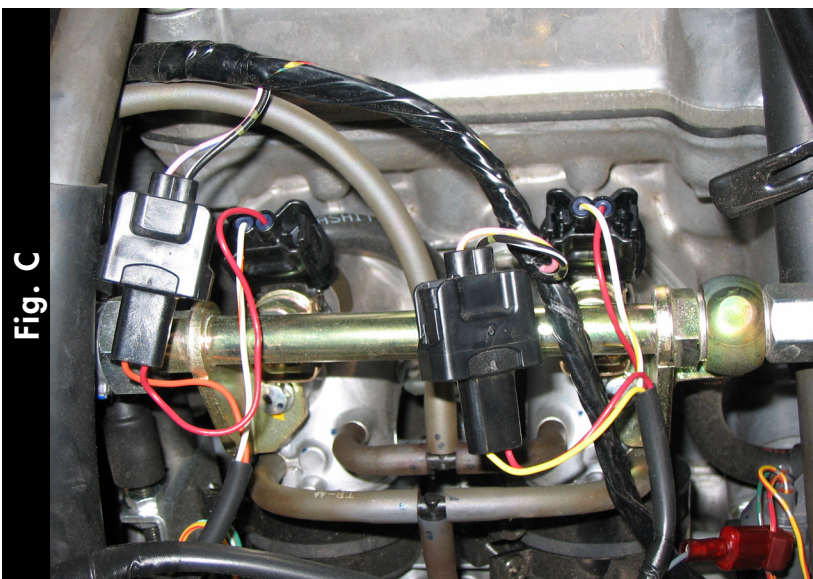

5 Plug the connectors from the PCIII in-line of the stock wiring harness and injectors (Fig.C).

*Connect the ORANGE colored wires to the left hand cylinder.*

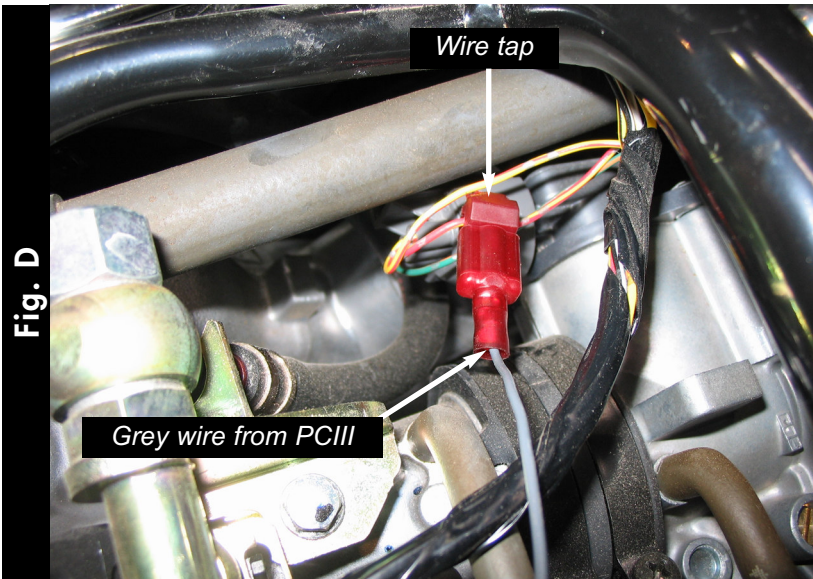

- 6 Locate the RED wire with the YELLOW stripe of the Throttle Position Sensor. The TPS is located on the right hand side of the throttle bodies.
- 7 Crimp the supplied wire tap to the RED/YELLOW wire (Fig. D).
- 8 Connect the GREY wire from the PCIII to the wire tap (Fig. D).

*It is recommended to use dielectric grease on these connections.*

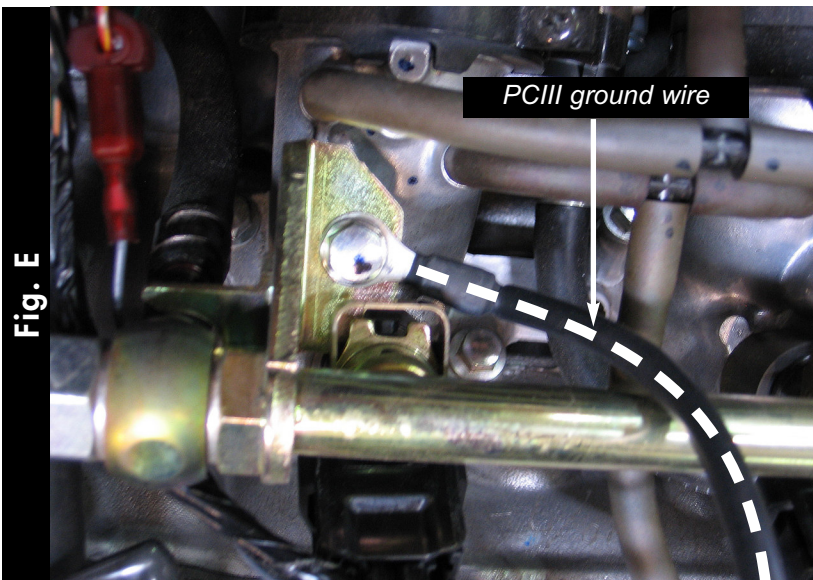

- 9 Attach the ground wire from the PCIII to the fuel rail mounting bolt (Fig. E).

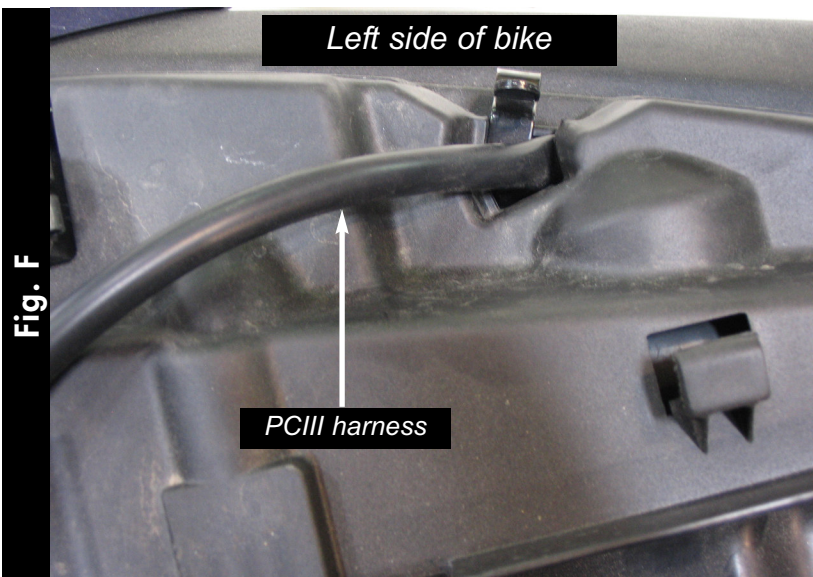

- 10 Reinstall the engine cover.
- 11 Route the PCIII harness out the left hand side of the cover where the cut-away is located (Fig. F).

Fig. G

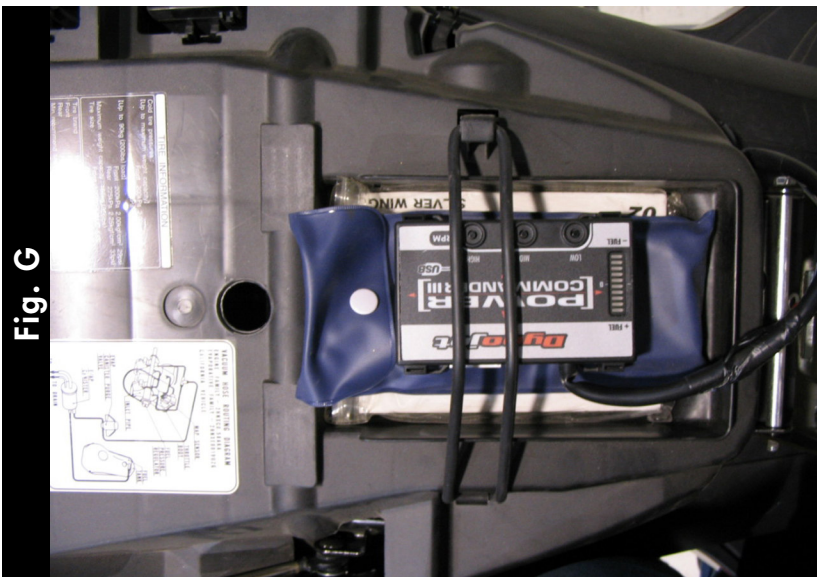

- 12 Install the PCI III in the tool kit location (Fig. G).
- 13 Reinstall the seat if it was removed.