

POWER COMMANDER FC

2007-2009 Suzuki Bandit 1250
2010-2012 Suzuki GSX1250F

Installation Instructions



Parts List

- | | |
|---|--------------------|
| 1 | Power Commander FC |
| 1 | USB Cable |
| 1 | Installation Guide |
| 2 | Dynojet Decals |
| 2 | Velcro |
| 1 | Alcohol swab |
| 1 | Posi-tap |
| 1 | O2 Optimizer |

**THE IGNITION MUST BE TURNED
OFF BEFORE INSTALLATION!**

YOU CAN ALSO DOWNLOAD THE PCFC
CONTROL CENTER SOFTWARE AND
LATEST MAPS FROM OUR WEB SITE AT:
www.powercommander.com

PLEASE READ ALL DIRECTIONS BEFORE STARTING INSTALLATION

Dynojet

2191 Mendenhall Drive North Las Vegas, NV 89081 (800) 992-4993 www.powercommander.com



Position	Note
Position 1	2007-2009 Suzuki Bandit 1250 Stock exhaust Stock air filter
Position 2	2010-2012 Suzuki GSX1250F European Model Stock exhaust Stock air filter

SELECTING THE MAP POSITION

The Dynojet Power Commander Fuel Controller (PCFC) comes loaded with up to ten maps. Using a #1 Phillips screwdriver, turn the map select dial to toggle between the loaded maps. Refer to the map position table for the maps included in your PCFC.

USING THE RPM RANGE DIALS

The Low, Mid, and High RPM Dials refer to the RPM range, in thirds, of your vehicle. Each dial allows +/- 10% fuel adjustment on top of what fuel changes are done in the map. With the dial facing straight up, there is no additional fuel change.

For example, if your vehicle revs to 6000 RPM:

- The low RPM dial will adjust 0-2000 RPM
- The mid RPM dial will adjust 2001-4000 RPM
- The high RPM dial will adjust 4001-6000 RPM

USING PCFC CONTROL CENTER

Take your tuning to the next level with the PCFC Control Center software.

- 1 Using your web browser, navigate to www.powercommander.com.
- 2 Click Enter Race Ready.
- 3 Click Downloads.
- 4 Click Access Downloads for Power Commander FC.
- 5 Click the PCFC software Download button.
- 6 Open the zip folder.
- 7 Double-click the install file and follow the on-screen instructions to install the PCFC Control Center software. The PCFC Control Center software and maps will be stored in C:\Program Files\PCFC Control Center.
- 8 Return to the Downloads or Home page where you can enter the make, model, and year of your bike to check for and download additional maps.

LOADING ADDITIONAL MAPS

- 1 Connect the USB cable from the computer to the PCFC. Verify the cable is fully seated in the PCFC.
- 2 Run the Control Center software by double-clicking the program icon installed on your desktop or on your start menu.
- 3 Click Open Map File and select a map file.
- 4 Click Send Map. You can send the map to any of the ten map positions.

ALTERING MAPS USING SOFTWARE

The values in the map represent a percentage of fuel change over stock. A value of 10 in the map indicates at that throttle position and RPM range the vehicle will be 10% richer than stock. If the value is -10, then it would be 10% leaner than stock. You have the ability to fine tune your fuel curve by altering these values. The Control Center software allows a value of +250 to -100 in each cell.

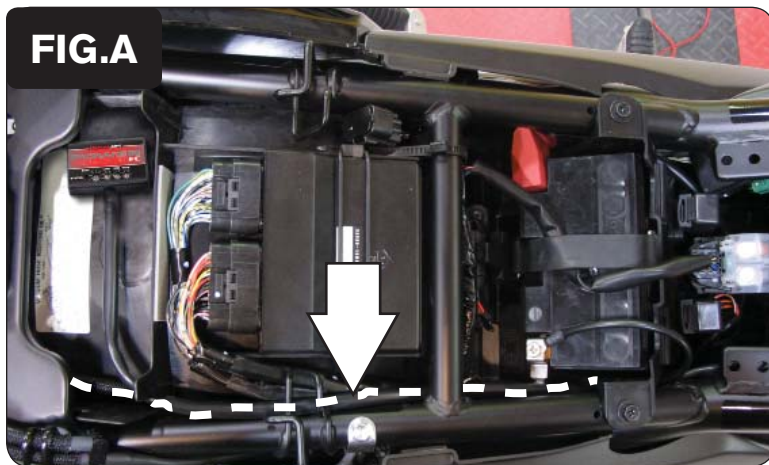

- 1 Remove the main seat.
- 2 Remove the fuel tank.
- 3 Lay the PCFC in the tail section.
- 4 Route the PCFC harness under the sub frame crossover and go towards the throttle bodies.

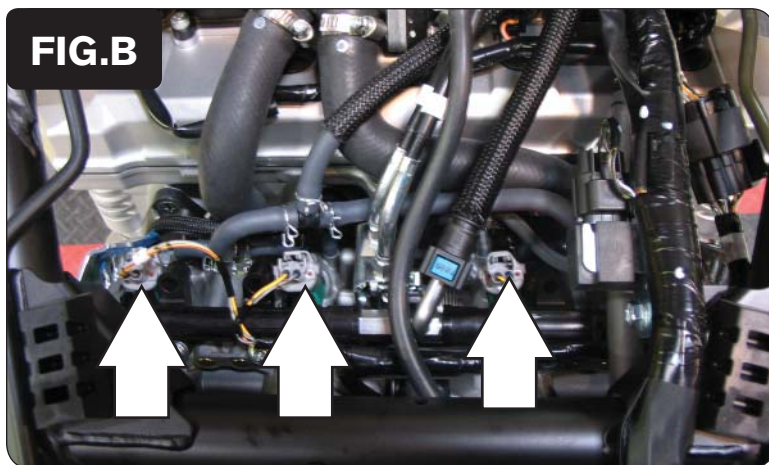

- 5 Unplug the stock wiring harness from each of the injectors as shown in Figure B.
Injector #4 is hidden in this picture by the main wiring harness.

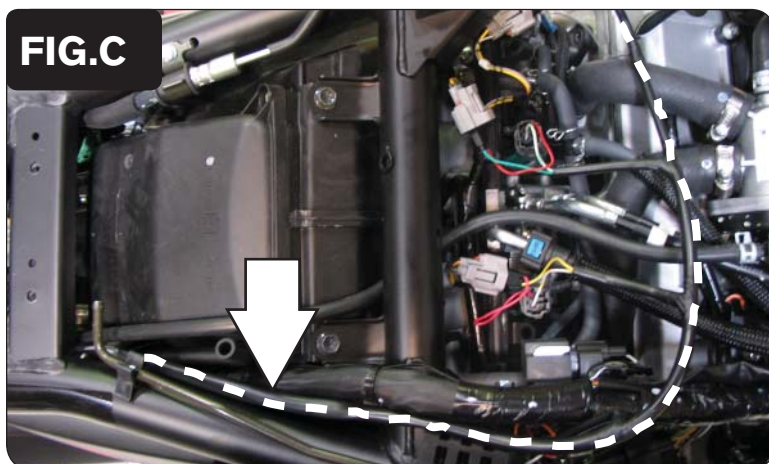

- 6 Attach the connectors from the PCFC to the stock injectors and the stock wiring harness as shown in Figure C.

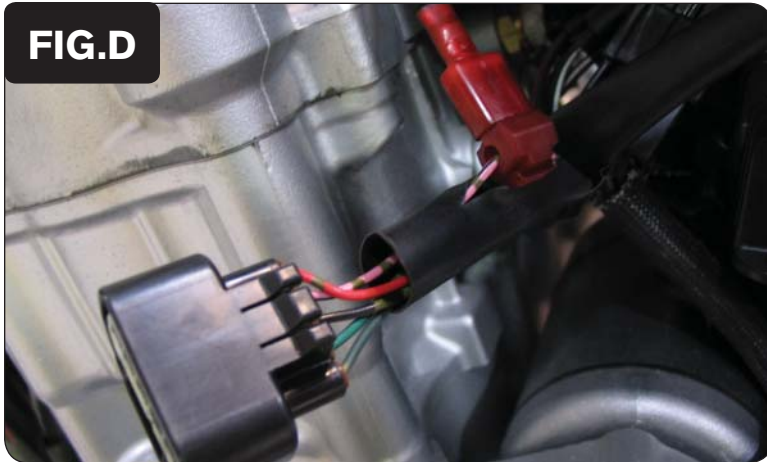
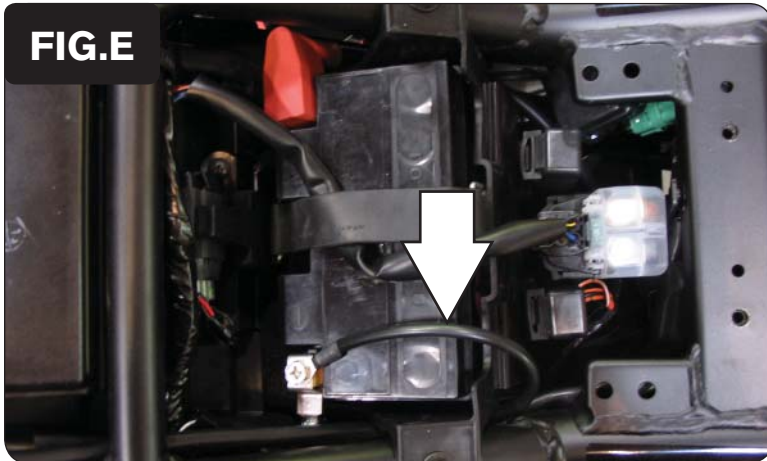
FIG.D**FIG.E**

- 7 Locate the Throttle Position Sensor (TPS).

The TPS is located on the left hand side of the throttle bodies.

- 8 Unplug the TPS connector to gain access to the wires.
- 9 Using the supplied posi-tap, attach the grey wire from the PCFC to the PINK wire with a BLACK stripe as shown in Figure D.

This connection can be done further up the harness than what is shown in Figure D for a cleaner install.

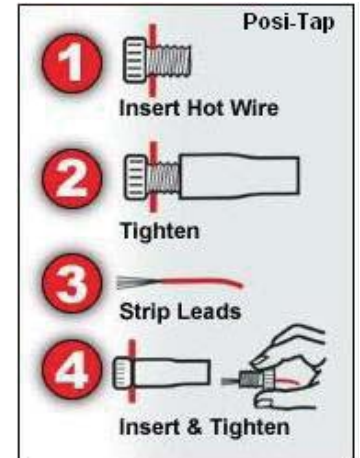

- 10 Attach the TPS connector back onto the throttle body.
- 11 Attach the ground wire from the PCFC to the negative side of the battery as shown in Figure E.
- 12 Reinstall the fuel tank.
Verify the PCFC harness does not get pinched.
- 13 Using the supplied velcro, secure the PCFC in the tail section of the trunk.
Make sure to clean both surfaces with the alcohol swab before attaching.
- 14 Locate the stock O2 sensor.
The stock O2 sensor is located under the left hand side cover.
- 15 Unplug the sensor from the stock wiring harness.
- 16 Attach the O2 optimizer to the main wiring harness.
The stock O2 sensor will not be connected to anything anymore.
- 17 Reinstall the seat.