

# **[POWER] COMMANDER III**

CERTIFIED **USB**

## **2003-2004 Kawasaki ZX6R** Installation Instructions

### **Parts List**

- 1 Power Commander
- 1 USB Cable
- 1 CD-ROM
- 1 Installation Guide
- 1 Power Adapter
- 2 Power Commander Decals
- 2 Dynojet Decals
- 1 Velcro® Strip
- 1 Alcohol Swab

Button Adjustment Display



Faceplate Buttons

**The ignition MUST be turned OFF before installation!**

You can also download the Power Commander software and latest maps from our web site at:

[www.powercommander.com](http://www.powercommander.com)

Expansion Port

USB Port



**PLEASE READ ALL DIRECTIONS BEFORE STARTING INSTALLATION**

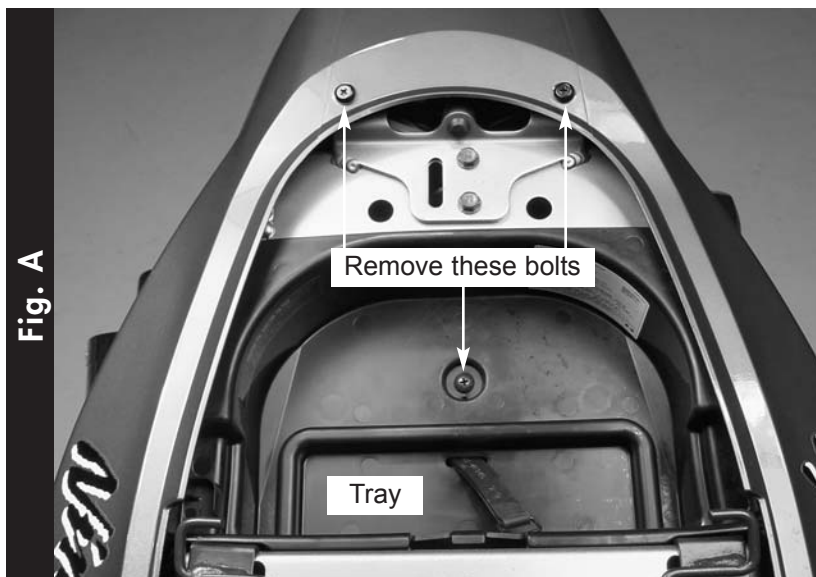

1. Remove the tail section by removing the six push pins on the underside of the tail section.
2. Remove the two bolts that hold the tail section to the subframe (Fig. A).

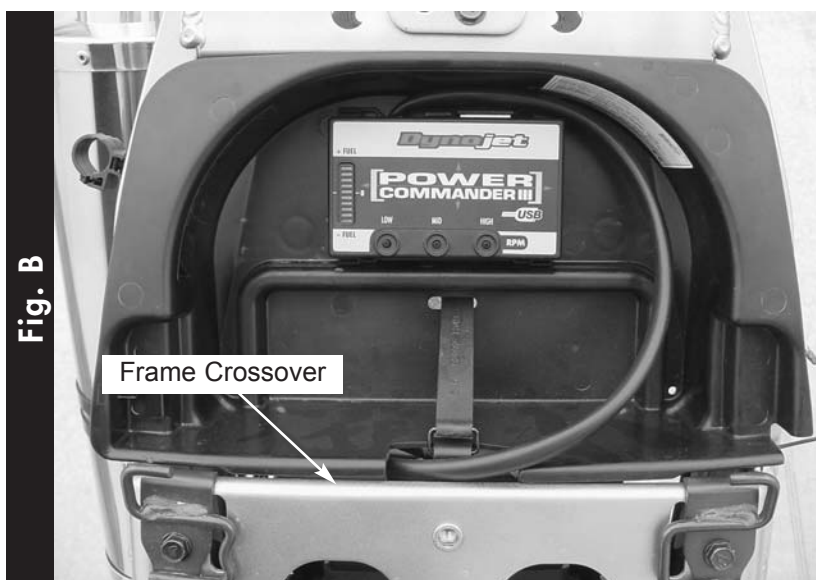

3. Pull the tray out of the tail section. To remove the tray remove the screw in the center of the tray (Fig. A). Route the PCIII harness under the frame crossover and thru the cutout in the tray (Fig. B).

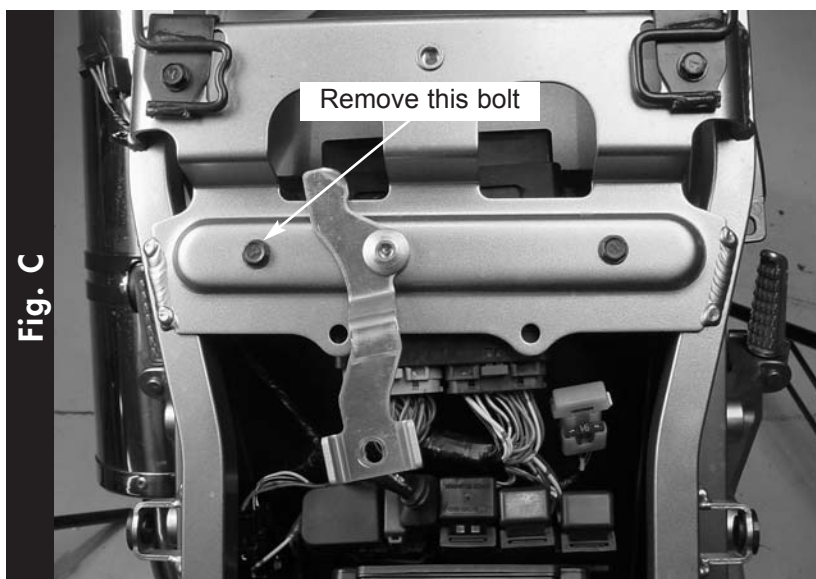

4. Remove the bolt shown in Fig. C. This allows the inner rear fender to be flexed downwards to allow clearance for the routing of the PCIII harness.



5. Route connectors from the PCIII one at a time between the frame and inner fender (Fig. D).

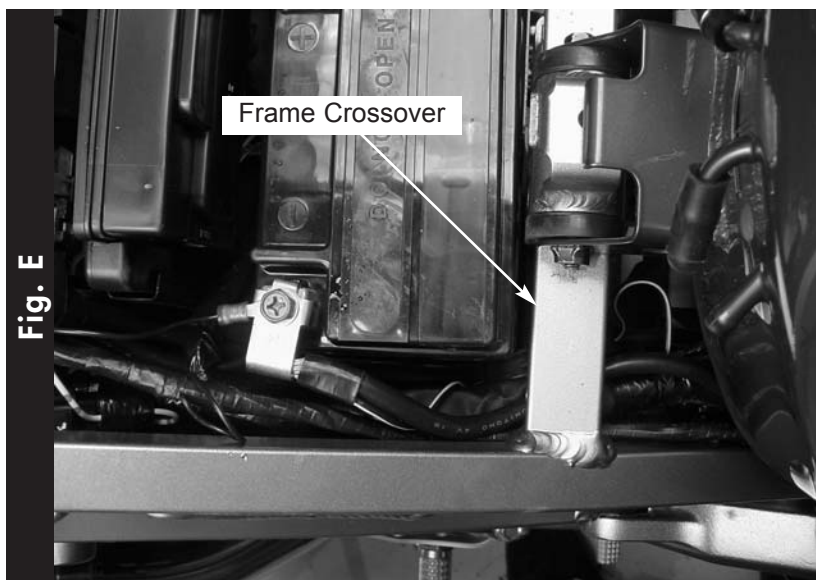

6. Route the PCIII harness under the frame crossover (Fig. E). The battery may need to be removed to allow clearance for the connectors and harness.

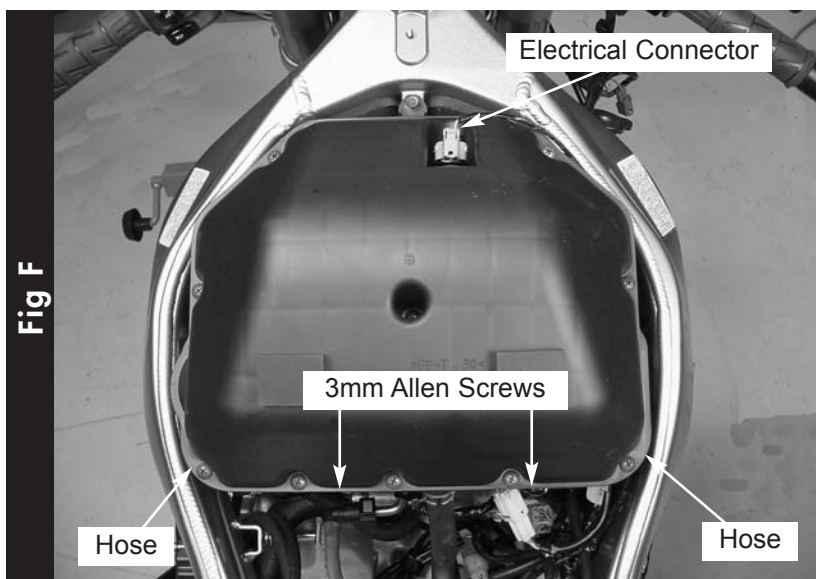

7. Lift the front of the fuel tank up. Remove the air box. To remove the air box loosen the the two 3mm allen screws at the rear of the air box (Fig. F). Also disconnect the hoses and electrical connector as shown in Fig. F.



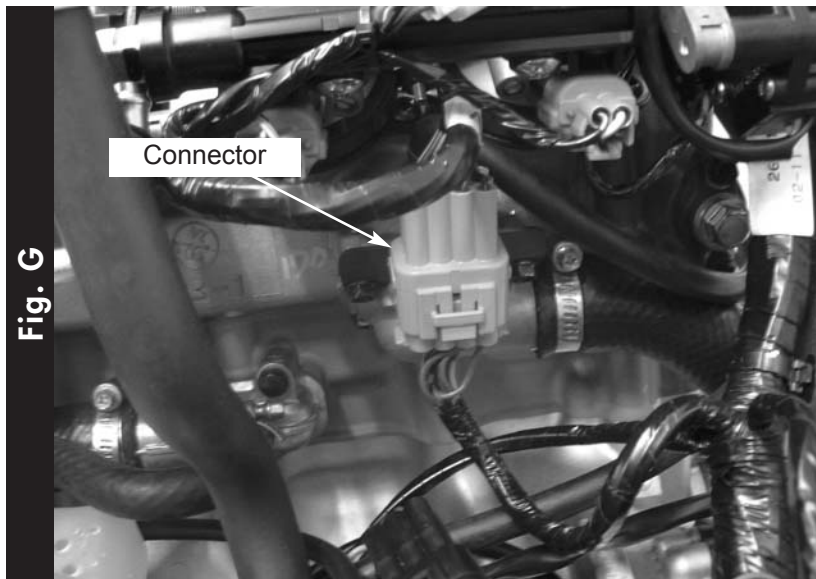

8. Unplug the throttle body connector (Fig. G). This connector is located underneath the throttle bodies.

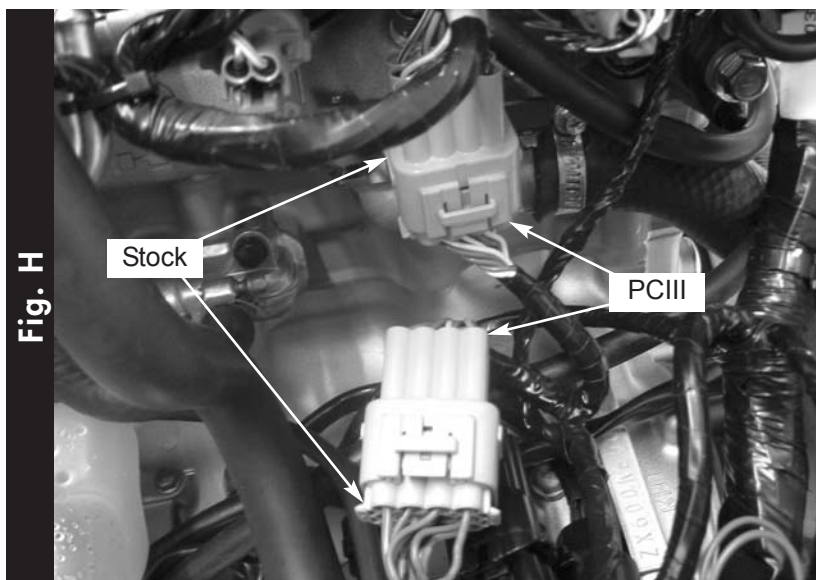

9. Plug the connectors that are closest to the PCIII unit in-line of the stock throttle body connector (Fig. H).

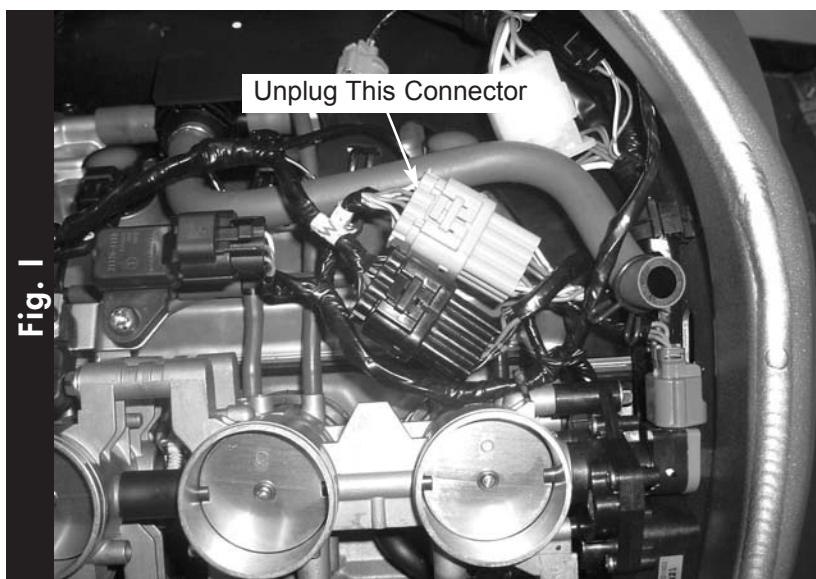

10. Unplug the Throttle Position Sensor connector. This connector is located in front of the throttle bodies on top of the valve cover and is the grey colored connector (Fig. I).

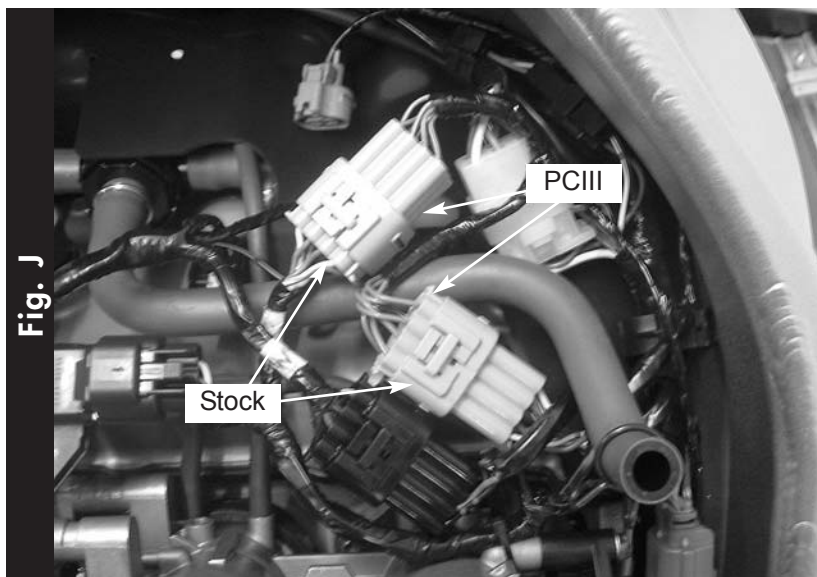

11. Plug the other connectors from the PCIII in-line of the stock TPS connectors (Fig. J).

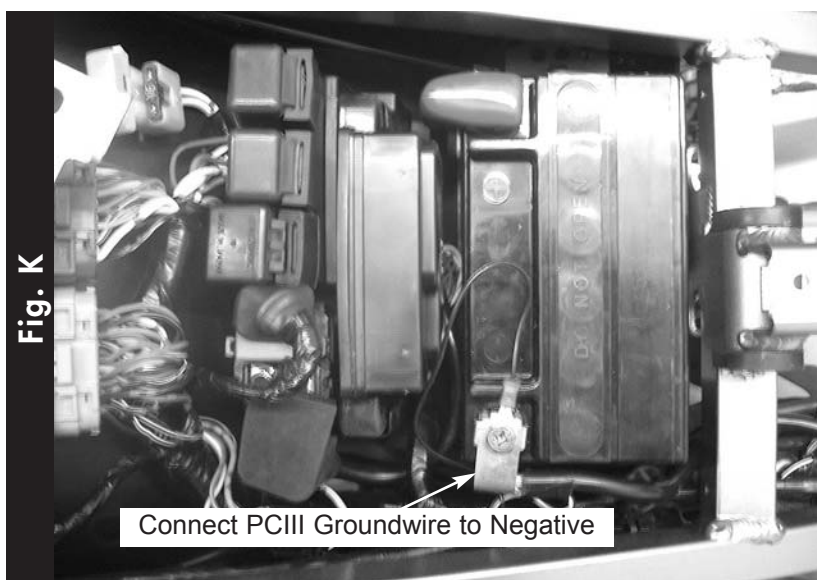

12. Connect the ground wire from the PCIII to the negative side of the battery (Fig. K).
13. Make sure all connections are secure and that the wiring harness will not get pinched or chaffed.
14. Reinstall the air box.
15. Reinstall the tail section.
16. Bolt the fuel tank down into position.