

# [POWER] [COMMANDER III]

CERTIFIED **USB**

## 2004-2007 Kawasaki Mean Streak 1600 Installation Instructions

### Parts List

- 1 Power Commander
- 1 USB Cable
- 1 CD-ROM
- 1 Installation Guide
- 1 Power Adapter
- 1 Wire Tap
- 2 Power Commander Decals
- 2 Dynojet Decals
- 2 Velcro® Strip
- 1 Alcohol Swab

**The ignition MUST be turned OFF before installation!**

You can also download the Power Commander software and latest maps from our web site at:

[www.powercommander.com](http://www.powercommander.com)

Button Adjustment Display



Faceplate Buttons

Expansion Port

USB Port



**PLEASE READ ALL DIRECTIONS BEFORE STARTING INSTALLATION**

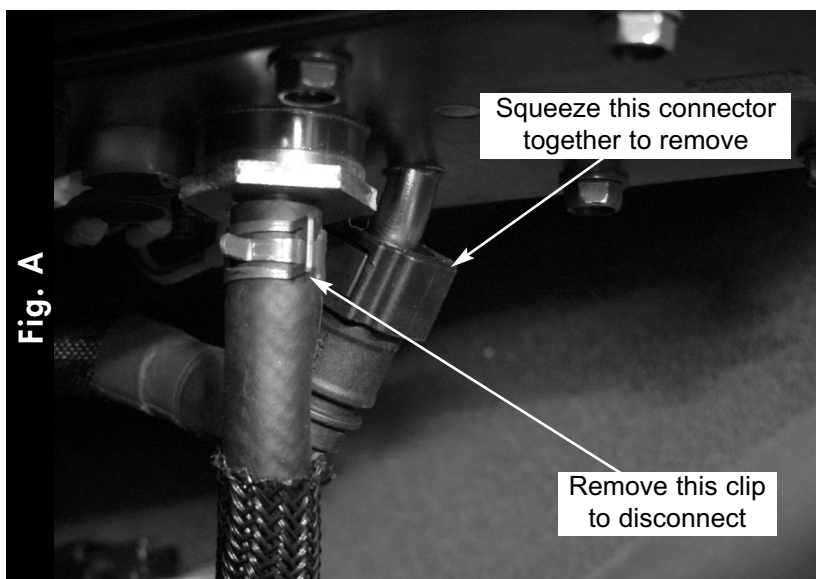

- 1 Remove the seat.
- 2 Remove the left side cover.
- 3 Remove the indicator light cluster assembly.
- 4 Unbolt the fuel tank.

**NOTE:** It is not necessary to remove the fuel tank. It does however make the installation easier. If you do remove the tank pay attention to the vent hose routing. Pressing the tabs on the black fuel line connector will allow the fuel line to be disconnected (Fig. A)

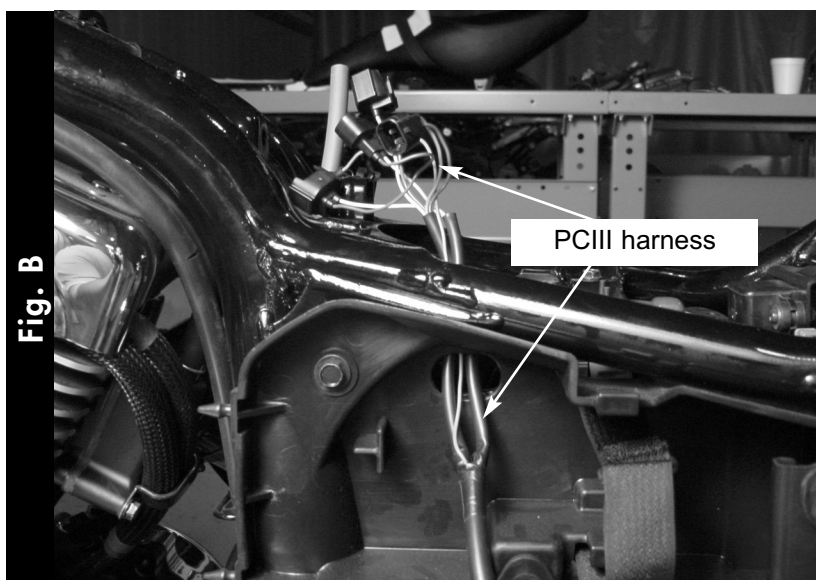

- 5 Route the wiring harness from the PCIII through the hole in the left hand side tray (Fig. B).

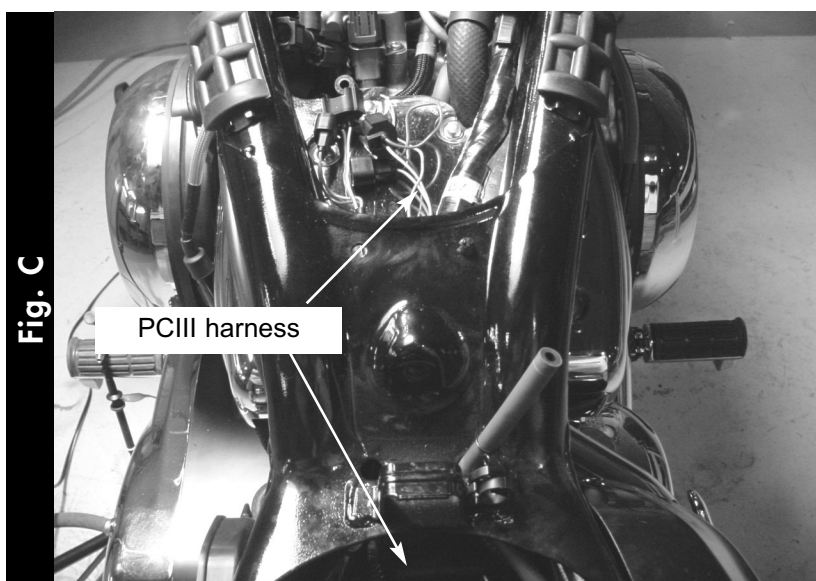

- 6 Route the PCIII harness under the frame and towards the throttle bodies (Fig. C).

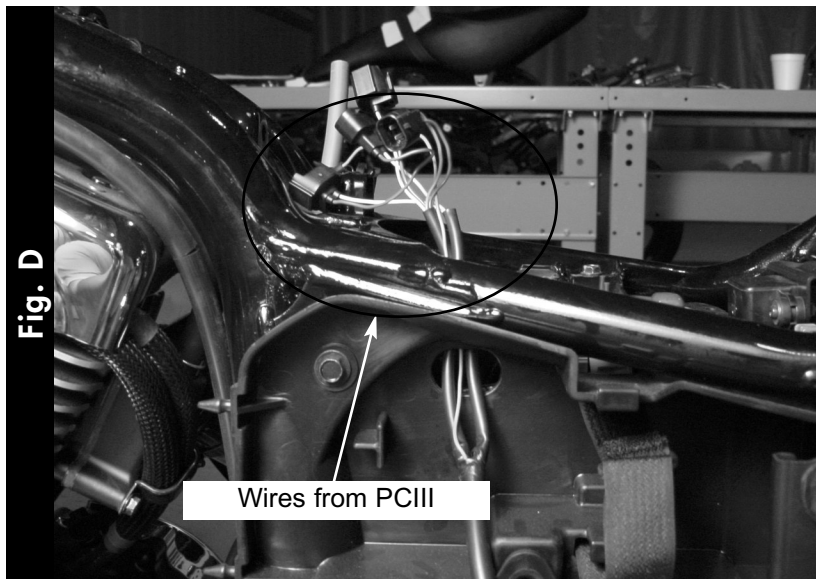

- 6b Closer view of the harness from the PCIII (Fig. D)

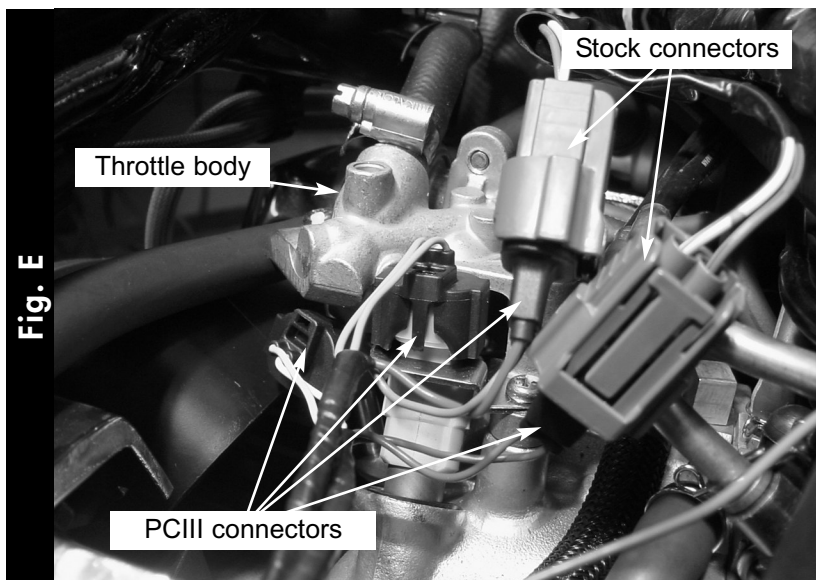

- 7 Plug the female PCIII connector with ORANGE/WHITE wire onto the front injector (Fig. E).
- 8 Connect the male PCIII connector with ORANGE wire onto the stock injector connector (Fig. E).
- 9 Repeat steps 7 thru 8 for rear injector using the PCIII connectors with the YELLOW colored wires.

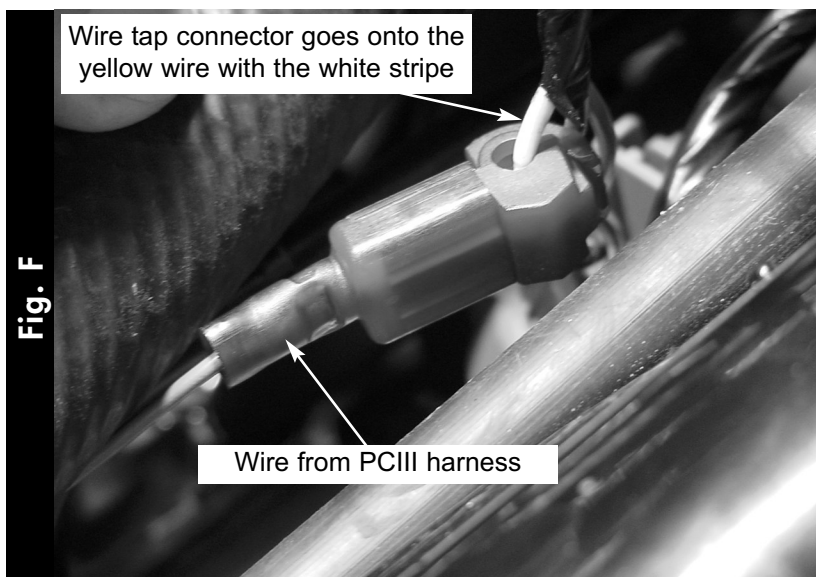

- 10 Locate the wires coming from the throttle position sensor. (Fig. F).
- 11 Attach the supplied wire tap onto the YELLOW wire with WHITE stripe. Firm pressure is required to close the connector. (Fig. F).
- 12 Plug the GREY wire with the spade terminal from the PCIII, into the wire tap (Fig. F). It is recommended to seal this connector with dielectric grease.

Fig. G

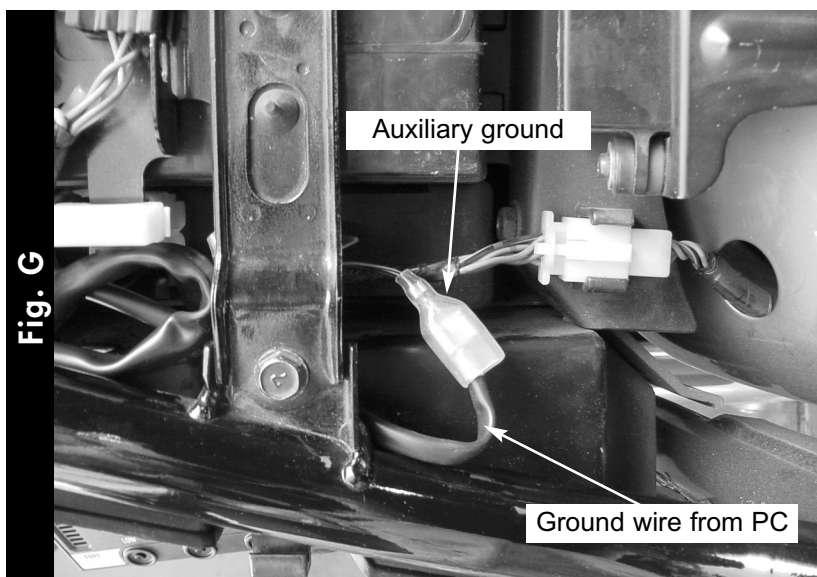

- 13 Reinstall the fuel tank.
- 14 Plug the ground wire from the PCIII into the auxiliary ground from the stock harness (Fig. G). The auxiliary ground can be found lying next to the battery. It has a double lead on a black wire with a yellow tracer.

Fig. H



- 15 Attach the PCIII module to the plastic tray (or the charcoal canister on California models) under the left side cover (Fig. H).
- 16 Reinstall the side cover.
- 17 Reinstall the seat.