

Thank you for purchasing this Dynojet kit. This kit has been developed for a motorcycle which is set to the parameters listed at the right in the "Stage" description. If your motorcycle does not meet any of these parameters please check with Dynojet before installation. For technical assistance contact your Dynojet distributor or call Dynojet U.S.A. (800)-992-4993

2191 Mendenhall Dr. Suite 105
North Las Vegas, NV 89031
TEL: 702-399-1423
FAX: 702-399-1431
8am-5pm Pacific Time
Monday through Friday

Website Address
<http://www.dynojet.com>

The manufacturer and seller make no warranties express or implied which extend beyond the description of the goods contained herein. Any description of this product is for the purpose of identifying it and shall not be deemed to create an express warranty.



2206.001

U.S Models Only

1997-2003 Kawasaki KLX300

Stage 2

For mildly tuned machines using the stock airbox with the lid removed and stock or K&N filter. May also be used with a good aftermarket exhaust system. K&N filter #KA-2587

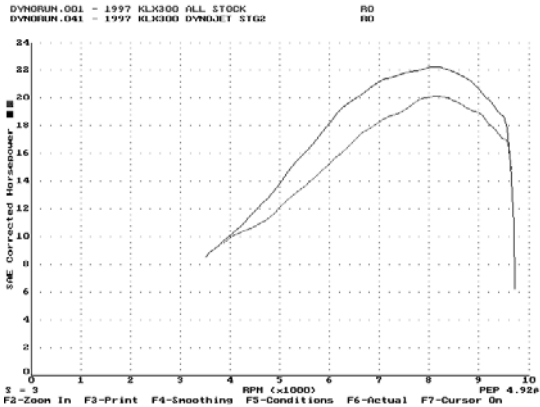

This graph shows a typical gain with a Dynojet jet kit.

WARNING

**NO SMOKING!
NO OPEN FLAME!
WHILE INSTALLING
YOUR JET KIT**

Parts List		
1	Main Jet	DJ120
1	Main Jet	DJ124
1	Main Jet	DJ128
1	Main Jet	DJ132
1	Fuel Needle	DNO352
1	E-clips	DE0001
1	Slide Drill	DD #32

STAGE TWO INSTRUCTIONS

DYNOJET
2206.001

Note: This kit is designed to be used with the airbox lid removed.

1. Remove the vacuum slide from the carb. Remove the stock needle and spacers, noting order of assembly (Fig.A).
2. Using the drill bit provided (DD #32) enlarge your slide lift holes (Fig. A). Drill your existing slide lift holes only, **do not drill the needle hole or any new holes.**
3. Install the Dynojet needle on groove #4 from the top. Use all stock spacers (Fig. A). After installing the slide in the carbs be sure to check slide movement manually.
4. Remove the stock main jet and replace with the Dynojet main jet provided.
With the stock exhaust with end cap on: Use the DJ 128 main jet at altitudes up to 3000 ft.
Use the DJ124 main jet at altitudes above 3000 ft and the DJ120 main jet at altitudes above 6000 ft.

With the stock exhaust with tned cap off: Use the DJ 132 main jet at altitudes up to 3000 ft.
Use the DJ128 main jet at altitudes above 3000 ft and the DJ124 main jet at altitudes above 6000 ft.

With an aftermarket exhaust: Because of varying configurations, the main jet and needle position can vary.
Use the DJ128 main jet and needle on groove #3 for a baseline at sea level.
Be sure that the jet you are changing is the main jet.

5. Locate the fuel mixture screw (Fig. B). Carefully turn the mixture screw clockwise until lightly seated, then back out 2-1/2 turns.

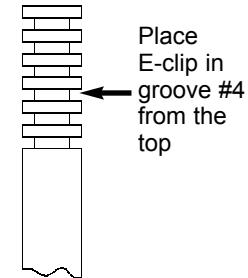

Fig. A

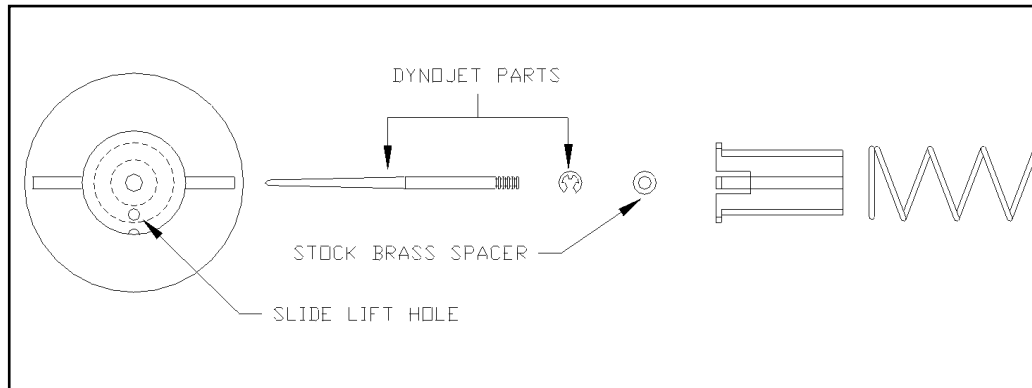

Fig. B

