

# **[POWER] COMMANDER III**

CERTIFIED **USB**

## **2008 Arctic Cat Prowler**

### **Installation Instructions**

#### **Parts List**

- 1 Power Commander
- 1 USB Cable
- 1 CD-ROM
- 1 Installation Guide
- 1 Power Adapter
- 2 Power Commander Decals
- 2 Dynojet Decals
- 2 Velcro® Strip
- 1 Alcohol Swab
- 1 Posi tap

**The ignition MUST be turned OFF before installation!**

You can also download the Power Commander software and latest maps from our web site at:

[www.powercommander.com](http://www.powercommander.com)

Button Adjustment Display

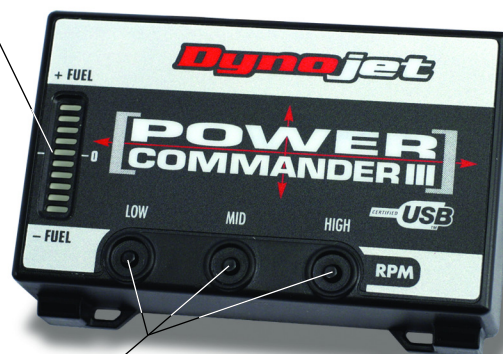

Faceplate Buttons

Expansion Port

USB Port



**PLEASE READ ALL DIRECTIONS BEFORE STARTING INSTALLATION**

Fig. A

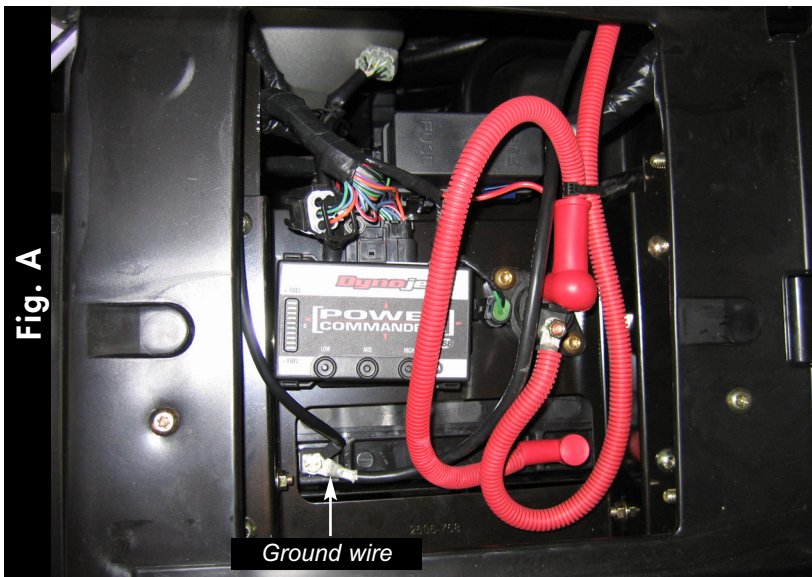

- 1 Remove both seats.
- 2 Remove the cover over the engine.
- 3 Attach the PCIII to the ECU using the supplied velcro (Fig. A).  
*Make sure to clean both surfaces with the alcohol swab before attaching.*
- 4 Attach the ground wire from the PCIII to the negative side of the battery.

Fig. B

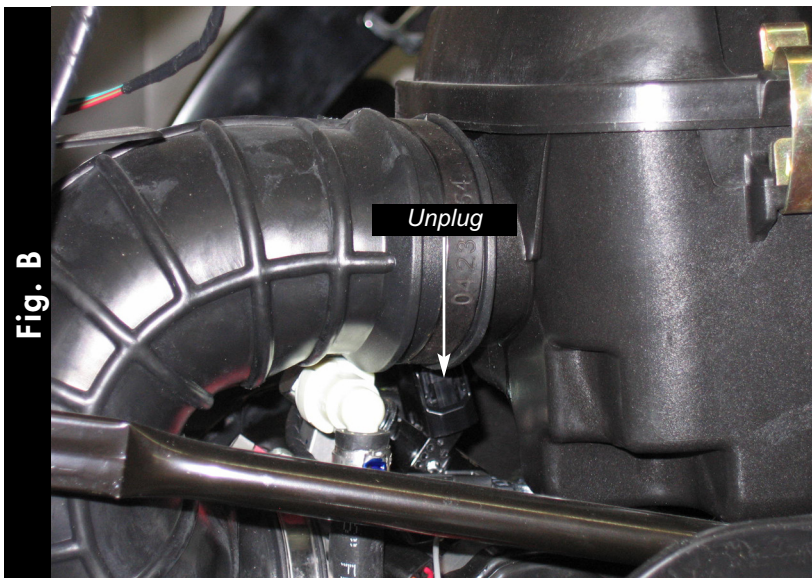

- 5 Route the PCIII harness under the seat tray and go towards the engine.
- 6 Unplug the stock wiring harness from the injector (Fig. B).

Fig. C

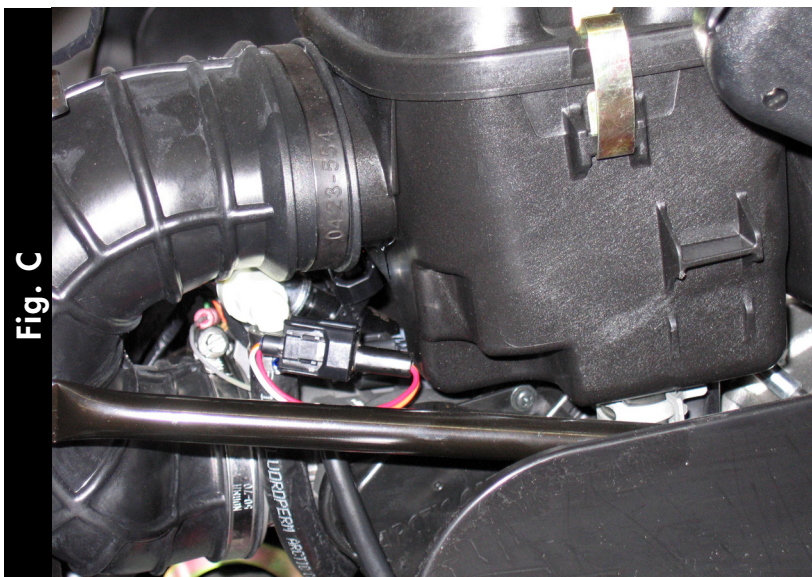

- 7 Plug the PCIII connectors in-line of the stock wiring harness and injector (Fig. C).



Fig. D

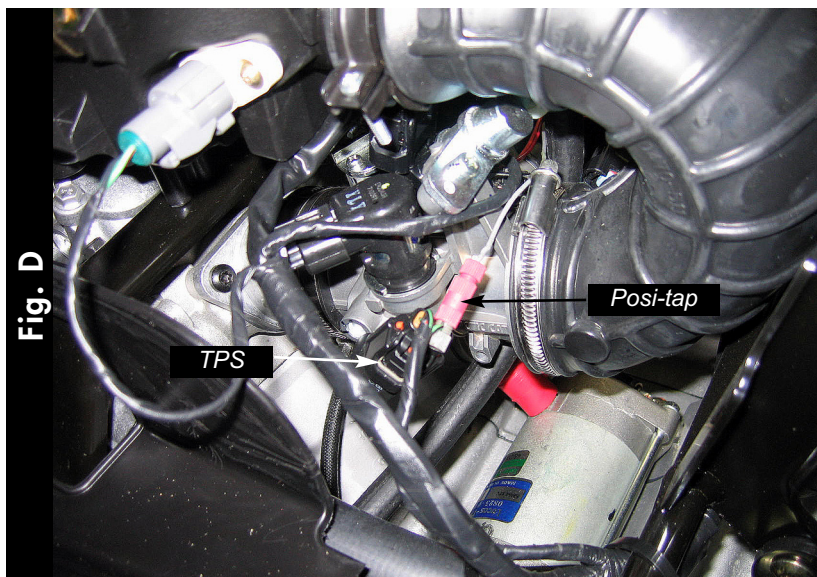

- 8 Locate the Throttle Position Sensor on the right hand side of the throttle body.
- 9 Using the supplied posi-tap connect the GREY wire of the PCIII to the GREEN/BLACK wire of the TPS.

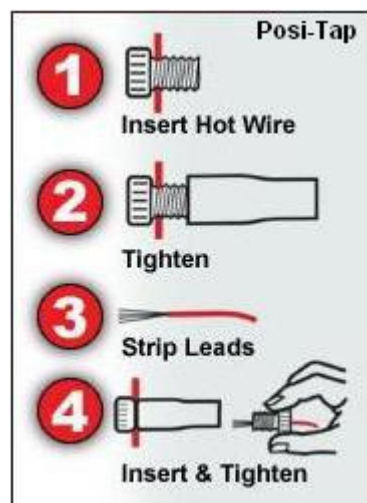

- 10 Reinstall the engine cover and seats.

*For more information on how to use and adjust the PCIII go to the HELP menu in the control center software.*