

Thank you for purchasing this Dynojet kit. This kit has been developed for a motorcycle which is set to the parameters listed at the right in the "Stage" description. If your motorcycle does not meet any of these parameters, please check with Dynojet before installation. For technical assistance contact your Dynojet distributor or call Dynojet U.S.A. (800)-992-4993



8121.001

U.S. Models Only

2000~2006 Harley Davidson
Twin Cam 88

For mildly tuned machines using the stock or high flow airbox. May also be used with a good after-market exhaust system, cams and piston kit.

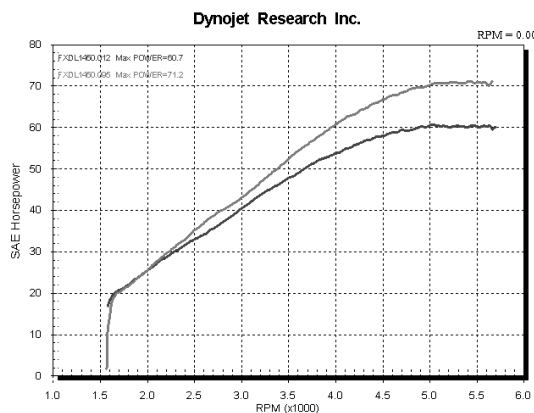

This graph shows a typical gain with a Dynojet jet kit.

WARNING
NO SMOKING!
NO OPEN FLAME!
WHILE INSTALLING
YOUR DYNOJET KIT

2191 Mendenhall Dr. Suite 105
North Las Vegas, NV 89081
TEL: 702-399-1423
FAX: 702-399-1431
8am-5pm Pacific Time
Monday through Friday

Website Address
<http://www.dynojet.com>

The manufacturer and seller make no warranties express or implied which extend beyond the description of the goods contained herein. Any description of this product is for the purpose of identifying it and shall not be deemed to create an express warranty.

Parts List		
1	Main Jet	DJ175
1	Main Jet	DJ180
1	Main Jet	DJ185
1	Main Jet	DJ190
1	Main Jet	DJ195
1	Main Jet	DJ200
1	Fuel Needle	DNO855
1	Slide Drill	DD #29
3	Adjusting Washers	DW0001
1	E-Clip	DE0001
1	Slide Spring	DSP088
1	Emulsion Tube	DET001
1	Plug Drill	DD #5/32
1	Screw	DS0001

INSTALLATION INSTRUCTIONS

DYNOJET
8121.001

1. Remove the vacuum slide from the carb. Remove the stock needle & spacers, noting order of assembly. Locate the slide lift hole using Fig. A, with slide drill DD #29 supplied, enlarge your slide lift hole.
2. Install the Dynojet needle on groove #4. Install the Dynojet washers above the E-clip (Fig. A).
3. Install the Dynojet spring in place of the stock spring, making sure that the spring is aligned properly.
4. Place the carb upside down on the bench. Remove the stock main jet and remove the emulsion tube (Fig. B), sometimes referred to as the main jet holder. Replace the stock emulsion tube with the Dynojet tube provided. When the Dynojet emulsion tube is fully seated there will still be threads visible. Install the Dynojet main jet provided. Use the DJ175 main jet with a completely stock bike. Use the DJ180 main jet with an aftermarket exhaust, or airbox. With aftermarket exhaust, airbox and cams, use the DJ185 main jet. If you have internal motor modifications, use the DJ195 main jet.
5. Locate the fuel mixture plug (Fig. B), if you see a screw head at the fuel mixture screw location, proceed to the adjusting procedure. With the DD #5/32 drill bit provided, carefully drill thru the plug. **Note:** the mixture screw is directly underneath this plug, be ready to pull back on the drill the instant you break thru. Use screw provided to secure and remove the plug. Carefully turn mixture screw clockwise until it seats, turn out 3-1/2 turns.

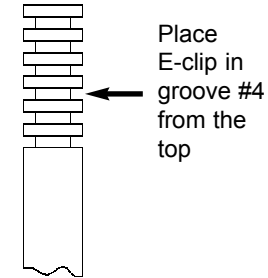

Fig. A

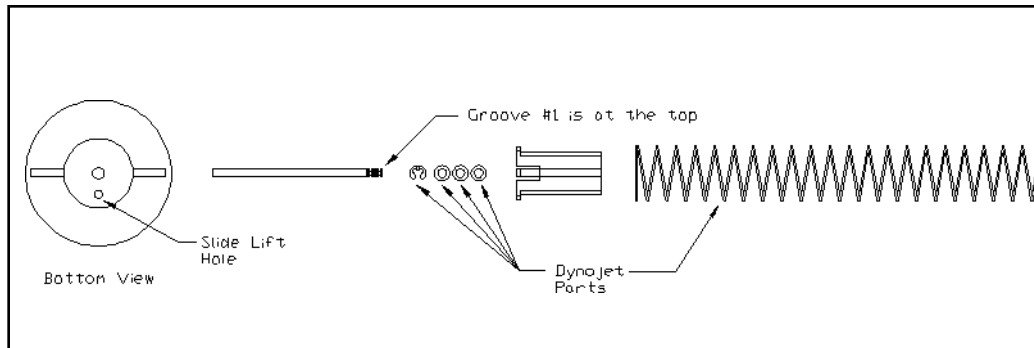

Fig. B

