

Thank you for purchasing this Dynojet kit. This kit has been developed for a motorcycle which is set to the parameters listed at the right in the "Stage" description. If your motorcycle does not meet any of these parameters please check with Dynojet before installation. For technical assistance contact your Dynojet distributor or call Dynojet U.S.A. (800)-992-4993

2191 Mendenhall Dr. Suite 105
 North Las Vegas, NV 89031
 TEL: 702-399-1423
 FAX: 702-399-1431
 8am-5pm Pacific Time
 Monday through Friday

Website Address
<http://www.dynojet.com>

The manufacturer and seller make no warranties express or implied which extend beyond the description of the goods contained herein. Any description of this product is for the purpose of identifying it and shall not be deemed to create an express warranty.



E1136.001

European Models Only

1998-2001 Honda NT650V
 Deauville
 Stage 1

For mildly tuned machines using the stock air-box, with stock or K&N filter. May also be used with a good aftermarket exhaust system
 K&N Filter # N/A

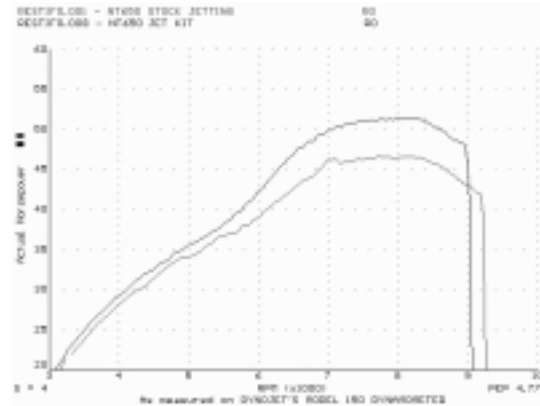

This graph shows a typical gain with a Dynojet jet kit.

WARNING

**NO SMOKING!
 NO OPEN FLAME!
 WHILE INSTALLING
 YOUR DYNोजET KIT**

Parts List

2	Main Jets	DJ122
2	Main Jets	DJ126
2	Fuel Needles	DNO129
2	Adjusting Washers	DW0001
2	E-Clips	DE0001

STAGE ONE INSTRUCTIONS

1. Remove the vacuum slide from the carbs. Remove stock needles & spacers, noting order of assembly. Locate the slide lift holes (Fig. A), the picture may not show your slide exactly. Using a two part epoxy, plug the lift hole shown in Fig. A. Allow to dry before final installation.

2. Install the Dynojet needles on groove #5, using all stock spacers (Fig. A). Install the Dynojet washers above the E-clip. When installing the needles. Remove the spring from the needle retainer, clip the plastic mounting stud to half of its original length. Replace the spring. This adds clearance for the Dynojet needle

3. Remove the main jet and replace with the Dynojet main jets provided. Use the DJ122 main jets with stock exhaust. Use the DJ126 main jets with aftermarket header or slip-on with high flowing baffles. Be sure that the jets you are changing are the main jets.

4. Locate the Fuel Mixture Screw Plug (Fig. B). If you see a screw at Fig. B proceed to the adjusting procedure. Carefully turn mixture screw clockwise until seated, then back out 2.5 turns.

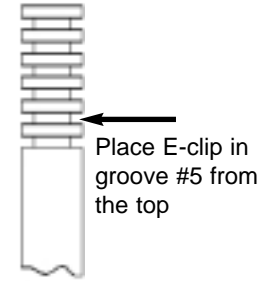

Fig. A

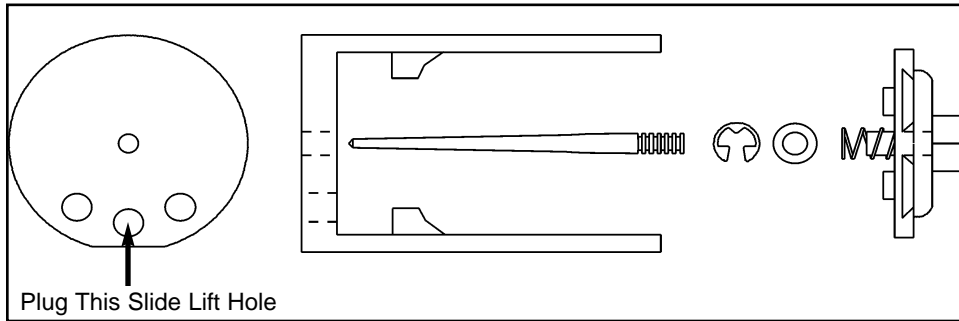

Fig. B

