

Thank you for purchasing this Dynojet kit. This kit has been developed for a motorcycle which is set to the parameters listed at the right in the "Stage" description. If your motorcycle does not meet any of these parameters please check with Dynojet before installation. For technical assistance contact your Dynojet distributor or call Dynojet U.S.A. (800)-992-4993

2191 Mendenhall Dr. Suite 105  
 North Las Vegas, NV 89031  
 TEL: 702-399-1423  
 FAX: 702-399-1431  
 8am-5pm Pacific Time  
 Monday through Friday

Website Address  
<http://www.dynojet.com>

The manufacturer and seller make no warranties express or implied which extend beyond the description of the goods contained herein. Any description of this product is for the purpose of identifying it and shall not be deemed to create an express warranty.



**E1164.001**

European Models Only

*1991-93 Honda CBR400RR*

**Stage 1**

For mildly tuned machines using the stock air-box, with stock or K&N filter. May also be used with a good aftermarket exhaust system  
 K&N filter #HA-0004

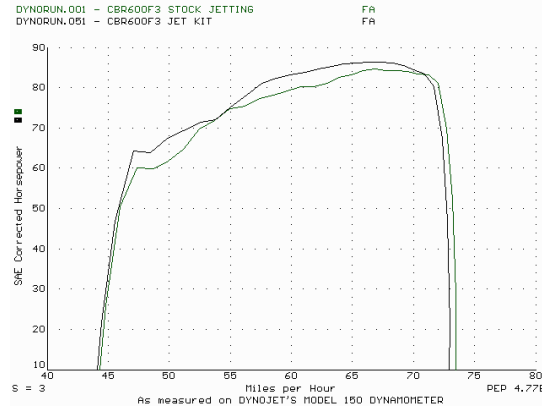

*This graph shows a typical gain with a Dynojet jet kit.*

# WARNING

**NO SMOKING!  
 NO OPEN FLAME!  
 WHILE INSTALLING  
 YOUR DYNOJET KIT**

## Parts List

4	Main Jets	DJ112
4	Main Jets	DJ116
4	Fuel Needles	DNO307
4	E-Clips	DE0001
4	Adjusting Washers	DW0001
4	Slide Springs	DSP007
1	Slide Drill	DD# 37
4	Needle Shrouds	DNJT02
1	Glue	DA0001
1	Shroud Tool	DT007

## STAGE ONE INSTRUCTIONS

**DYNOJET**  
E1164.001

1. Remove vacuum slides from carbs. Remove stock needles and spacers noting order of assembly (Fig. B). Locate slide lift holes and drill both with the drill bit (DD# 37) supplied.
2. Locate Dynojet part# DNJT02 supplied. With cutaway facing up and to the engine (Fig. A), use the shroud tool provided (DT007) to press over stock needle jet and hold. Before pressing down, add a touch of glue to the outer base of the stock needle jet, then press down. Check to make sure there is no excess glue visible.
3. Install Dynojet needles on groove #2 from the top. Use all stock spacers. Install the small Dynojet washers above the E-clip.
4. Install the Dynojet springs in place of the stock springs. Make sure the springs are aligned properly.
5. Remove the stock main jets and replace with the Dynojet main jets provided. If you are using the stock exhaust install the DJ112 main jets. If you are using an aftermarket exhaust or slip-on with a high flowing baffle, use the DJ116 main jets. Be sure that the jets you are changing are the main jets.
6. Locate the fuel mixture screw (Fig. C). Carefully turn mixture screw clockwise until lightly seated, then turn out 2-1/2 turns.

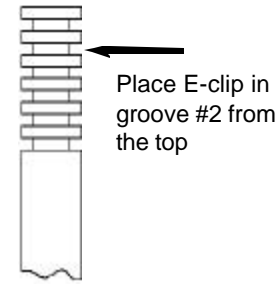

Fig. A

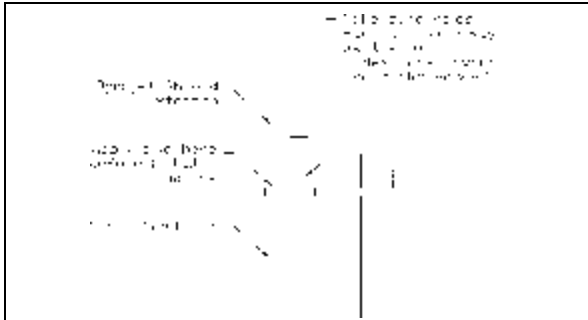

Fig. B

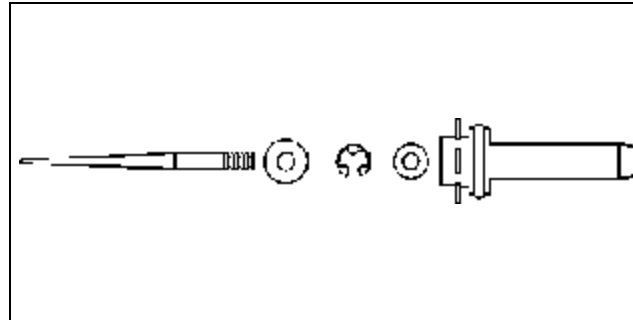

Fig. C

