

Thank you for purchasing this Dynojet kit. This kit has been developed for a motorcycle which is set to the parameters listed at the right in the "Stage" description. If your motorcycle does not meet any of these parameters please check with Dynojet before installation. For technical assistance contact your Dynojet distributor or call Dynojet U.S.A. (800)-992-4993

2191 Mendenhall Dr. Suite 105  
 North Las Vegas, NV 89031  
 TEL: 702-399-1423  
 FAX: 702-399-1431  
 8am-5pm Pacific Time  
 Monday through Friday

Website Address  
<http://www.dynojet.com>

The manufacturer and seller make no warranties express or implied which extend beyond the description of the goods contained herein. Any description of this product is for the purpose of identifying it and shall not be deemed to create an express warranty.



**E1196.001**

European Models Only

*1999-2000 Honda CBR600F4*

**Stage 1**

For mildly tuned machines using the stock air-box, with stock or K&N filter. May also be used with a good aftermarket exhaust system  
 K&N filter #HA-0021



*This graph shows a typical gain with a Dynojet jet kit.*

# WARNING

**NO SMOKING!  
 NO OPEN FLAME!  
 WHILE INSTALLING  
 YOUR DYNOJET KIT**

## Parts List

2	Main jets	DJ110
2	Main jets	DJ112
2	Main jets	DJ114
2	Main jets	DJ116
2	Main jets	DJ118
4	Fuel Needles	DNO200
4	E-Clips	DE0001
4	Adjusting Washers	DW0001
4	Main Air Jet Plugs	DCO500
4	Slide Springs	DSP008
1	Main Air Jet Tool	DT001
1	Glue	DA0001

# STAGE ONE INSTRUCTIONS

**DYNOJET**

**E1196.001**

1. Remove vacuum slides from carbs. Remove spring from slide. Thread one of the slide cover screws into the center of the needle retainer (Fig. A) and pull up gently. Remove stock needles and spacers, noting order of assembly (Fig. B).
2. Install Dynojet needles on groove #3 from the top. Using all stock spacers (Fig. B). Install the small Dynojet washers above the E-clip. Install the stock needle retainers with the Dynojet springs. After installing the slides in the carbs be sure to check slide movement manually.
3. Remove the carb bell mouths (Fig. D). Using DT001 tool provided tap the DCO500 main air jet plugs into place (Fig. E), open end out. Reinstall the bell mouths. **NOTE: THE MAIN AIR JET PLUGS MUST BE INSTALLED FOR THIS KIT TO FUNCTION PROPERLY.**
4. Remove the stock main jets and replace with Dynojet main jets provided. If you are running the stock exhaust install the DJ112 main jets in the outside carburetors and DJ114 main jets in the inner carburetors. If you are running an aftermarket exhaust or slip-on with a high flowing baffle, use the DJ114 main jets in the outside carburetors and DJ116 main jets in the inner carburetors. The DJ110 main jets are for high altitude applications.
5. Locate the fuel mixture screw (Fig. C). Carefully turn the screws clockwise until they lightly seat and then back out 3 turns.

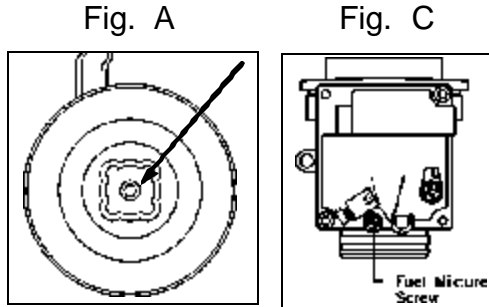
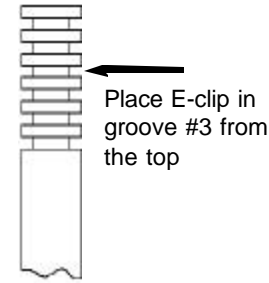

Fig. B

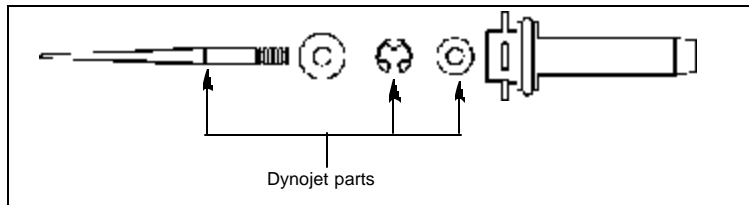

Fig. D

Carb Bell Mouth

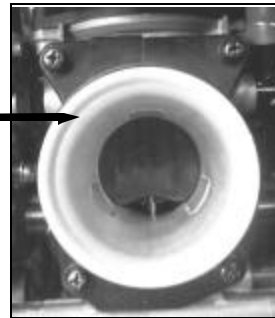

Fig. E

Plug this hole with the DCO500

