

Thank you for purchasing this Dynojet kit. This kit has been developed for a motorcycle which is set to the parameters listed at the right in the "Stage" description. If your motorcycle does not meet any of these parameters please check with Dynojet before installation. For technical assistance contact your Dynojet distributor or call Dynojet U.S.A. (800)-992-4993

2191 Mendenhall Dr. Suite 105  
North Las Vegas, NV 89031  
TEL: 702-399-1423  
FAX: 702-399-1431  
8am-5pm Pacific Time  
Monday through Friday

Website Address  
<http://www.dynojet.com>

The manufacturer and seller make no warranties express or implied which extend beyond the description of the goods contained herein. Any description of this product is for the purpose of identifying it and shall not be deemed to create an express warranty.



**E2176.001**

European Models Only

*1999-02 Kawasaki W650*

**Stage 1**

For mildly tuned machines using the stock airbox,  
with stock or K&N filter. May also be used with a  
good aftermarket exhaust system  
K&N filter # N/A

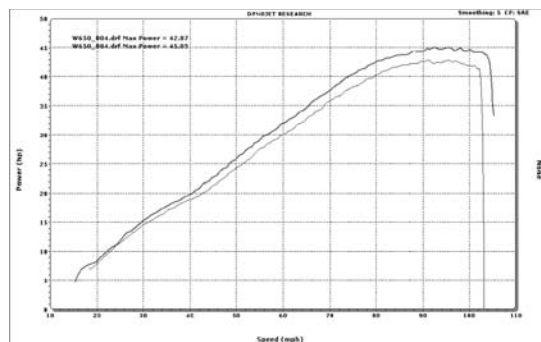

*This graph shows a typical gain with a Dynojet jet kit.*

# WARNING

**NO SMOKING!  
NO OPEN FLAME!  
WHILE INSTALLING  
YOUR DYNOJET KIT**

## Parts List

2	Main Jets	DJ106
2	Main Jets	DJ108
2	Main Jets	DJ110
2	Main Jets	DJ112
2	Main Jets	DJ114
2	Fuel Needles	DNO119A
2	Slide Springs	DSP005
4	Adjusting Washers	DW0001
2	E-Clips	DE0001

## STAGE ONE INSTRUCTIONS

1. Remove the vacuum slide from the carbs. Remove the stock needles & spacers, noting the order of assembly.
2. Install the Dynojet needles on groove # 2, using all stock spacers (Fig. A). Install the adjusting washers above the e-clip (2 per needle). Install the Dynojet slide springs (DSP005) inplace of the stock slide springs.
3. Remove the main jet and replace with the Dynojet main jets provided. Use the DJ108 main jets with stock exhaust. Use the DJ112 main jets with aftermarket headers or slip-ons with free flowing baffles. Be sure that the jets you are changing are the main jets.
4. Locate the fuel mixture screw (Fig. B). Carefully turn mixture screw clockwise until lightly seated, then back out until you find your best idle. Our base setting is 3 1/2 turns.

Fig. A

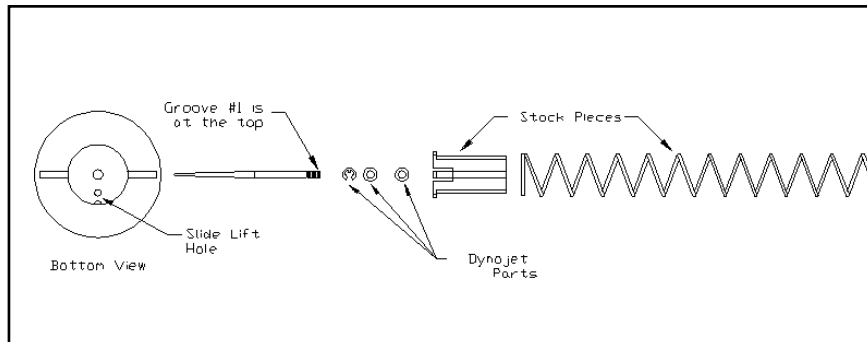
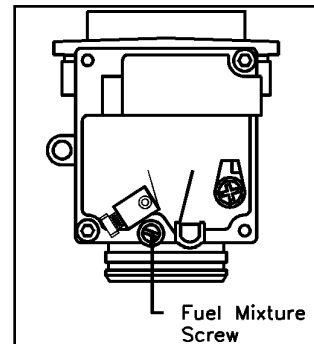

Fig. C



Place E-clip in  
groove #2 from  
the top

