

Thank you for purchasing this Dynojet kit. This kit has been developed for a motorcycle which is set to the parameters listed at the right in the "Stage" description. If your motorcycle does not meet any of these parameters please check with Dynojet before installation. For technical assistance contact your Dynojet distributor or call Dynojet U.S.A. (800)-992-4993



**E3126.001**

European Models Only

*1987-2000 Suzuki 1400  
Intruder*

**Stage 1**

For mildly tuned machines using the stock air-box, with stock or K&N filter. May also be used with a good aftermarket exhaust system  
K&N filter #N/A

2191 Mendenhall Dr. Suite 105  
North Las Vegas, NV 89031  
TEL: 702-399-1423  
FAX: 702-399-1431  
8am-5pm Pacific Time  
Monday through Friday

Website Address  
<http://www.dynojet.com>

The manufacturer and seller make no warranties express or implied which extend beyond the description of the goods contained herein. Any description of this product is for the purpose of identifying it and shall not be deemed to create an express warranty.

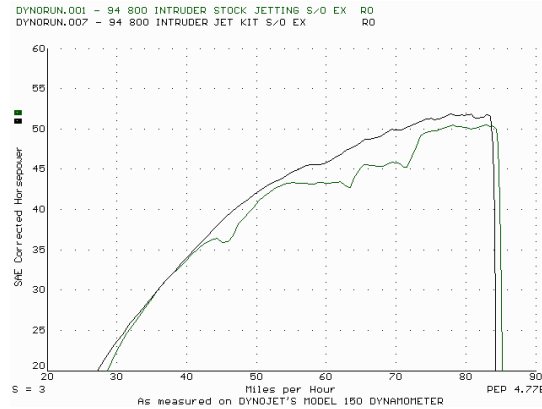

*This graph shows a typical gain with a Dynojet jet kit.*

# WARNING

**NO SMOKING!  
NO OPEN FLAME!  
WHILE INSTALLING  
YOUR DYNOJET KIT**

## Parts List

2	Main Jets	DJ144
2	Main Jets	DJ150
2	Fuel Needles	DNO117M
2	Adjusting Washers	DW0001
2	E-clips	DE0001
1	Slide Drill	DD #7/64

## STAGE ONE INSTRUCTIONS

**DYNOJET**  
E3126.001

**NOTE: It is not necessary to remove the carburetors to install this kit.**

1. Remove vacuum slides from carbs. Remove stock needles and spacers, noting order of assembly (Fig. A). Using the slide drill (DD #7/64) provided, enlarge the slide lift hole (Fig. A). **Do not drill the needle hole.**
2. Use the stock main jets. If you have a problem using the stock mains and you are running the stock exhaust, use the DJ144 main jets. If you continue to have problems, try using the DJ150 main jets.
3. Install Dynojet needles on groove #3. Use all stock spacers (Fig. A). Install the small Dynojet washers above the e-clip (2 per needle). After installing the slides in the carbs be sure to check slide movement manually.
4. Locate the fuel mixture screw (Fig. B). Carefully turn mixture screws clockwise until lightly seated, then back out 2 1/2 turns.

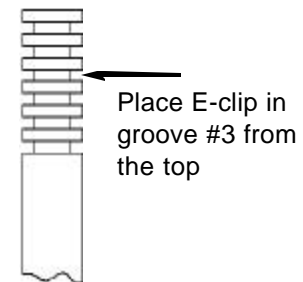

Fig. A

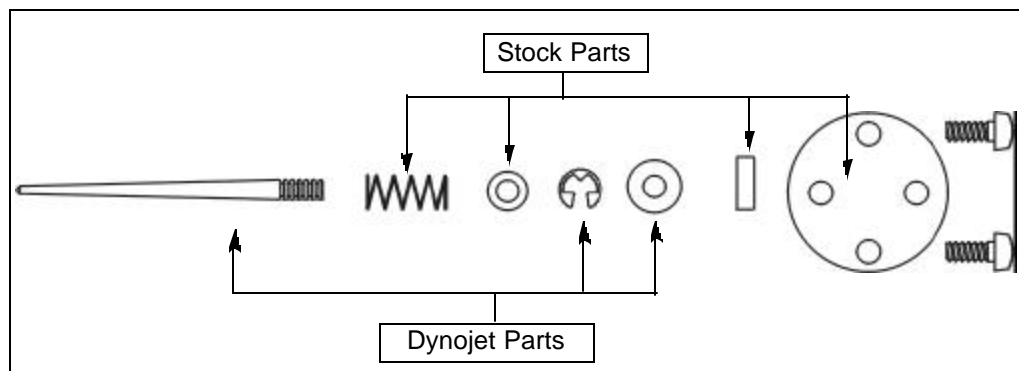

Fig. B

