

Thank you for purchasing this Dynojet kit. This kit has been developed for a motorcycle which is set to the parameters listed at the right in the "Stage" description. If your motorcycle does not meet any of these parameters please check with Dynojet before installation. For technical assistance contact your Dynojet distributor or call Dynojet U.S.A. (800)-992-4993



**E3X18.002**

European Models Only

*1985-87 Suzuki GSXR750*

**Stage 3**

For mildly tuned machines using the stock air-box, with stock or K&N filter. May also be used with a good aftermarket exhaust system  
K&N filter #RC-1824

2191 Mendenhall Dr. Suite 105  
North Las Vegas, NV 89031  
TEL: 702-399-1423  
FAX: 702-399-1431  
8am-5pm Pacific Time  
Monday through Friday

Website Address  
<http://www.dynojet.com>

The manufacturer and seller make no warranties express or implied which extend beyond the description of the goods contained herein. Any description of this product is for the purpose of identifying it and shall not be deemed to create an express warranty.

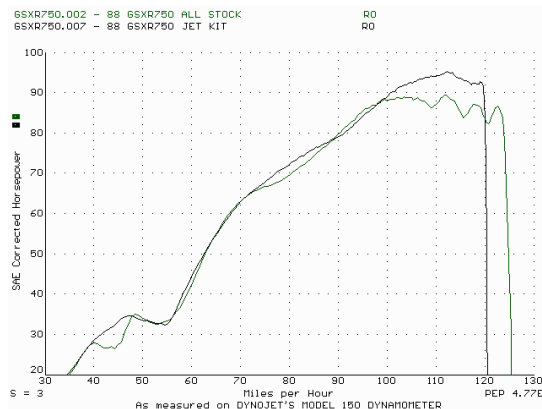

*This graph shows a typical gain with a Dynojet jet kit.*

# WARNING

**NO SMOKING!  
NO OPEN FLAME!  
WHILE INSTALLING  
YOUR DYNOJET KIT**

## Parts List

|   |                   |        |
|---|-------------------|--------|
| 4 | Main Jets         | DJ130  |
| 4 | Main Jets         | DJ134  |
| 4 | Main Jets         | DJ138  |
| 4 | Fuel Needles      | DNO358 |
| 4 | Adjusting Washers | DW0001 |
| 4 | E-clips           | DE0001 |

## STAGE THREE INSTRUCTIONS

**DYNOJET**  
**E3X18.002**

1. Remove the vacuum slide from the carbs. Remove the stock needles & spacers, noting the order of assembly.

2. Install the Dynojet needles on groove #3, using all stock spacers (Fig. A).

3. Remove the main jet and replace with the Dynojet main jets provided. Use the DJ134 main jets with stock exhaust, or use the DJ138 main jets with aftermarket exhaust. Be sure that the jets you are changing are the main jets.

4. Locate the fuel mixture screw (Fig. B). Carefully turn mixture screw clockwise until seated, then back out 2-1/2 turns.

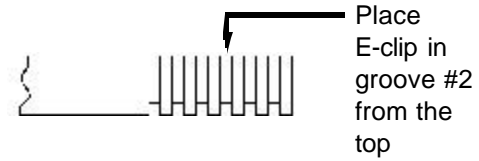

Fig. A

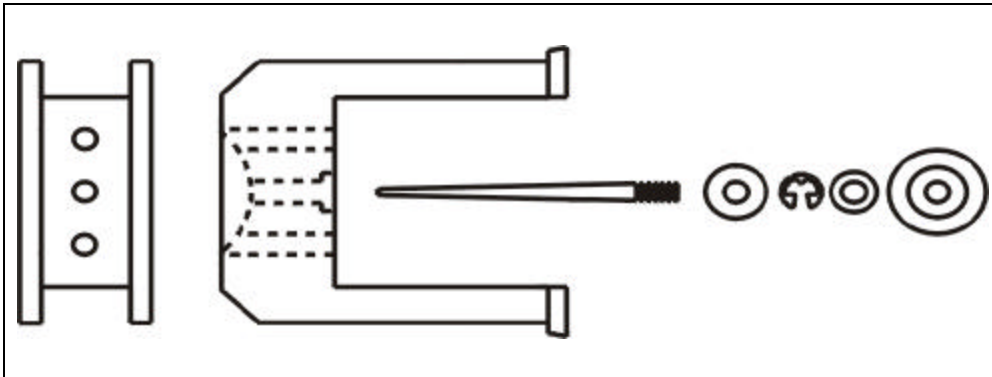

Fig. B

