

Thank you for purchasing this Dynojet kit. This kit has been developed for a motorcycle which is set to the parameters listed at the right in the "Stage" description. If your motorcycle does not meet any of these parameters please check with Dynojet before installation. For technical assistance contact your Dynojet distributor or call Dynojet U.S.A. (800)-992-4993

2191 Mendenhall Dr. Suite 105
 North Las Vegas, NV 89031
 TEL: 702-399-1423
 FAX: 702-399-1431
 8am-5pm Pacific Time
 Monday through Friday

Website Address
<http://www.dynojet.com>

The manufacturer and seller make no warranties express or implied which extend beyond the description of the goods contained herein. Any description of this product is for the purpose of identifying it and shall not be deemed to create an express warranty.



E4101.001

European Models Only

1980-83 Yamaha XJ1100 & XS1100

Stage 1&3

STAGE 1

For mildly tuned machines using the stock airbox, with stock or K&N filter #YA-1400

STAGE 3

For mildly tuned machines using individual filters or velocity stacks. K&N filters #RC-0984

Both stages may also be used with a good aftermarket slip-on.

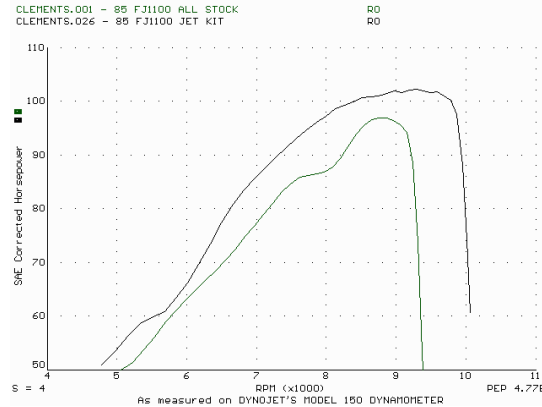

This graph shows a typical gain with a Dynojet jet kit.

WARNING

**NO SMOKING!
 NO OPEN FLAME!
 WHILE INSTALLING
 YOUR DYNOJET KIT**

Parts List

4	Main Jets	DJ124
4	Main Jets	DJ128
4	Main Jets	DJ138
4	Pilot Air Jets	DJ190
1	Slide Drill	DD #39
4	Fuel Needles	DNT604
4	Adjusting Washers	DW0001
4	E-Clips	DE0001

STAGE ONE INSTRUCTIONS

1. Remove the vacuum slide from the carbs.
Remove the stock needles & spacers, noting order of assembly. Use the slide drill (DD #39) provided to enlarge slide lift hole(Fig. A).
2. Install Dynojet needles on groove# 2, using all stock spacers(Fig. A). Install the Dynojet washers above the e-clip.
3. Remove the main jet and replace with the Dynojet main jets provided. Use the DJ124 main jets with stock exhaust, or use the DJ128 main jets with free flowing aftermarket exhaust. Be sure that the jets you are changing are the main jets.
4. Locate the pilot air jet (Fig. B). Remove the stock air jets and install the pilot air jets (DJ190) supplied.
5. Locate the Fuel Mixture Screw (Fig. C). Carefully turn mixture screw clockwise until seated, then back out until you find your best idle. Base setting is 4 turns.

Fig. A

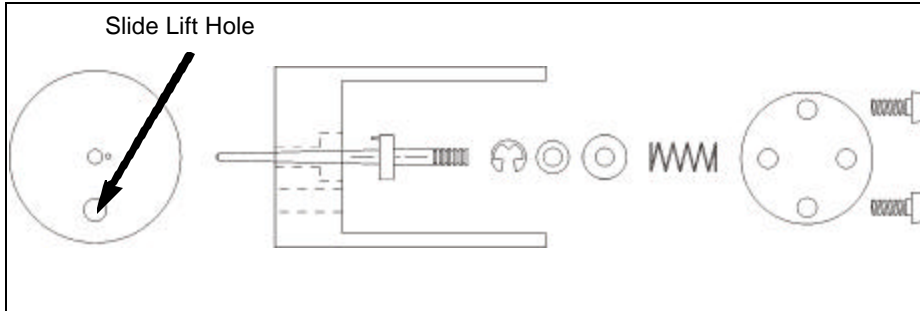

STAGE THREE INSTRUCTIONS

1. Remove the vacuum slide from the carbs.
Remove the stock needles & spacers, noting order of assembly. Use the slide drill (DD #39) provided to enlarge slide lift hole (Fig. A).
2. Install the Dynojet needles on groove #2, using all stock spacers (Fig. A). Install the Dynojet washers above the E-clip.
3. Remove the main jet and replace with the Dynojet main jets provided. Use the DJ138 main jets. Be sure that the jets you are changing are the main jets.
4. Locate the pilot air jet (Fig. B). Remove the stock air jets and install the pilot air jets (DJ190) supplied.
5. Locate the Fuel Mixture Screw (Fig. C). Carefully turn mixture screw clockwise until seated, then back out until you find your best idle. Base setting is 4 turns.

Fig. B

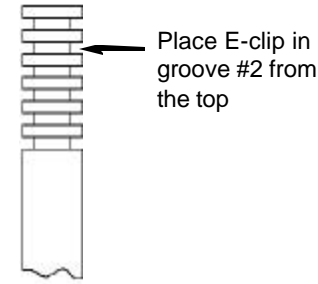
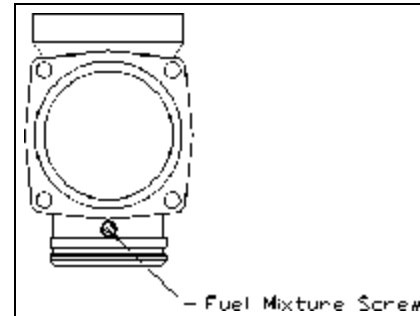

Fig. C

