

Thank you for purchasing this Dynojet kit. This kit has been developed for a motorcycle which is set to the parameters listed at the right in the "Stage" description. If your motorcycle does not meet any of these parameters please check with Dynojet before installation. For technical assistance contact your Dynojet distributor or call Dynojet U.S.A. (800)-992-4993

2191 Mendenhall Dr. Suite 105  
 North Las Vegas, NV 89031  
 TEL: 702-399-1423  
 FAX: 702-399-1431  
 8am-5pm Pacific Time  
 Monday through Friday

Website Address  
<http://www.dynojet.com>

The manufacturer and seller make no warranties express or implied which extend beyond the description of the goods contained herein. Any description of this product is for the purpose of identifying it and shall not be deemed to create an express warranty.



**E4105.001**

European Models Only

1984-85 Yamaha FJ1100

Stage 1&3

**STAGE 1**

For mildly tuned machines using the stock airbox, with stock or K&N filter #YA-1184

**STAGE 3**

For mildly tuned machines using individual filters or velocity stacks. K&N filters #RC-2914

Both stages may also be used with a good aftermarket slip-on.

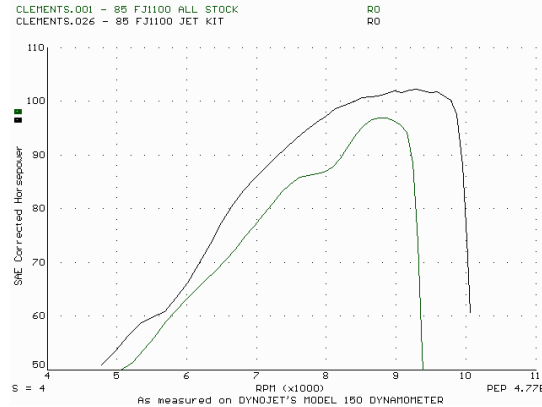

*This graph shows a typical gain with a Dynojet jet kit.*

**WARNING**

**NO SMOKING!  
 NO OPEN FLAME!  
 WHILE INSTALLING  
 YOUR DYNOJET KIT**

**Parts List**

|   |                   |        |
|---|-------------------|--------|
| 4 | Main Jets         | DJ110  |
| 4 | Main Jets         | DJ114  |
| 4 | Main Jets         | DJ116  |
| 4 | Main Jets         | DJ120  |
| 1 | Slide Drill       | DD #28 |
| 4 | Fuel Needles      | DNT724 |
| 4 | Adjusting Washers | DW0001 |
| 4 | E-Clips           | DE0001 |

**STAGE ONE INSTRUCTIONS**

1. Remove the vacuum slide from the carbs. Remove the stock needles & spacers, noting order of assembly. If your bike is an 85 model proceed to step 2. If your bike is an 84 model, use the slide drill (DD #28) provided to enlarge slide lift hole (Fig. A).
2. Install Dynojet needles on groove #4, using all stock spacers (Fig. A). Install the Dynojet washers above the e-clip.
3. Remove the main jets and replace with the Dynojet main jets provided. Use the DJ114 main jets with stock exhaust, or use the DJ110 main jets with street baffles. Be sure that the jets you are changing are the main jets.
4. Locate the fuel mixture screw (Fig. B), Carefully turn mixture screw clockwise until seated, then back out 3 turns.

**STAGE THREE INSTRUCTIONS**

1. Remove the vacuum slide from the carbs. Remove the stock needles & spacers, noting order of assembly. If your bike is an 85 model proceed to step 2. If your bike is an 84 model, use the slide drill (DD #28) provided to enlarge slide lift hole (Fig. A).
2. Install Dynojet needles on groove #4, using all stock spacers (Fig. A). Install the Dynojet washers above the e-clip.
3. Remove the main jets and replace with the Dynojet main jets provided. Use the DJ116 main jets with stock exhaust, or use the DJ120 main jets with aftermarket exhaust. Be sure that the jets you are changing are the main jets.
4. Locate fuel mixture screw (Fig. B). Carefully turn mixture screw clockwise until seated, then back out 3 turns.

**NOTE:**

Flooding at low speeds can be caused by too high of a float level or too rich of a setting on the fuel mixture screws. If this occurs, try removing the floats and cleaning on top of the floats to remove any dirt that may be lodged there.

Place E-clip in groove #4 from the top



Fig. A

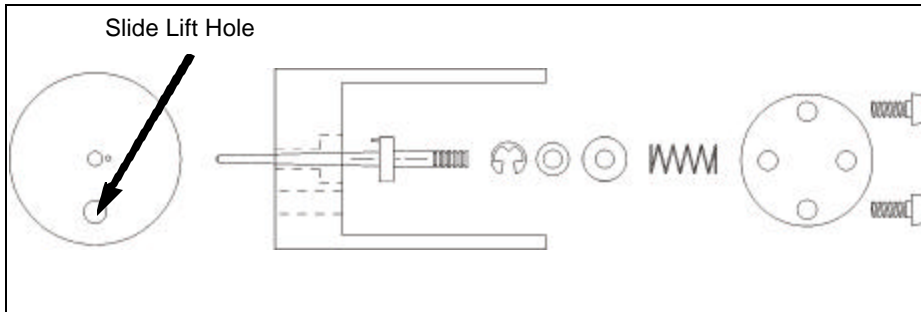

Fig. B

