

Thank you for purchasing this Dynojet kit. This kit has been developed for a motorcycle which is set to the parameters listed at the right in the "Stage" description. If your motorcycle does not meet any of these parameters please check with Dynojet before installation. For technical assistance contact your Dynojet distributor or call Dynojet U.S.A. (800)-992-4993

2191 Mendenhall Dr. Suite 105
 North Las Vegas, NV 89031
 TEL: 702-399-1423
 FAX: 702-399-1431
 8am-5pm Pacific Time
 Monday through Friday

Website Address
<http://www.dynojet.com>

The manufacturer and seller make no warranties express or implied which extend beyond the description of the goods contained herein. Any description of this product is for the purpose of identifying it and shall not be deemed to create an express warranty.



E4116.001

European Models Only

1985-2000 Yamaha V-Max

Stage 1

For mildly tuned machines using the stock airbox with stock or K&N filter. May also be used with a good aftermarket exhaust system
 K&N filter #YA-0076

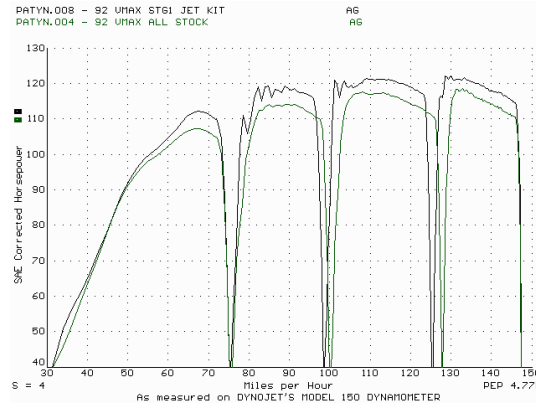

This graph shows a typical gain with a Dynojet jet kit.

WARNING

**NO SMOKING!
 NO OPEN FLAME!
 WHILE INSTALLING
 YOUR DYNOJET KIT**

Parts List		
4	Main Jet	DJ160
4	Main Jet	DJ165
4	Main Jet	DJ170
4	Pilot Air Jet	DJ150
4	Fuel Needles	DNT306
4	E-Clips	DE0001
4	Slide Springs	DSP044
4	Adjusting Washers	DW0001
1	Slide Drill	DD #19

STAGE ONE INSTRUCTIONS

DYNOJET
E4116.001

1. Remove vacuum slide from carbs. Remove stock needles & spacers, noting order of assembly. Use the slide drill provided(DD# 19) to enlarge the slide lift holes. Do not drill the needle hole.
2. Install Dynojet needles on groove# 3, using all stock spacers. Install the Dynojet washer above the E-clip.
3. Install the Dynojet slide springs in place of the stock slide springs.
4. Remove stock main jets and replace with Dynojet mains provided. If you are running the stock exhaust use the DJ165, if you are running an aftermarket header or slip-on with high flowing baffle, use the DJ170. Be sure that the jet you are changing is the main jet.
5. Locate the Fuel Mixture Plug(Fig. B), if you see a screw head at Fig. B proceed to adjusting procedure. Carefully turn mixture screws clockwise until they seat, turn out 2-1/2 turns.

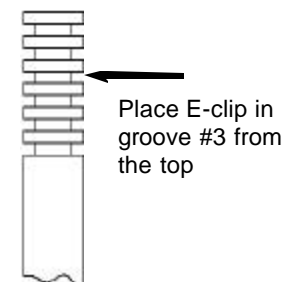

Note:

1. The pilot air jet is optional (DJ150), using this jet will richen the 0-1/8 throttle openings. Use the pilot air jet to fix problems that the needle cannot fix. See Fig. C for location.

Fig. A

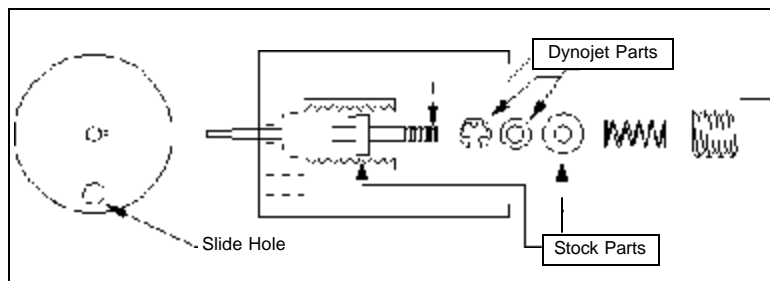

Fig. B

