

Thank you for purchasing this Dynojet kit. This kit has been developed for a motorcycle which is set to the parameters listed at the right in the "Stage" description. If your motorcycle does not meet any of these parameters please check with Dynojet before installation. For technical assistance contact your Dynojet distributor or call Dynojet U.S.A. (800)-992-4993

2191 Mendenhall Dr. Suite 105
 North Las Vegas, NV 89031
 TEL: 702-399-1423
 FAX: 702-399-1431
 8am-5pm Pacific Time
 Monday through Friday

Website Address
<http://www.dynojet.com>

The manufacturer and seller make no warranties express or implied which extend beyond the description of the goods contained herein. Any description of this product is for the purpose of identifying it and shall not be deemed to create an express warranty.



E4123.001

European Models Only

1988-98 Yamaha XV1100 Virago

Stage 1

For mildly tuned machines using the stock air-box, with stock or K&N filter. May also be used with a good aftermarket exhaust system.
 K&N filter #N/A

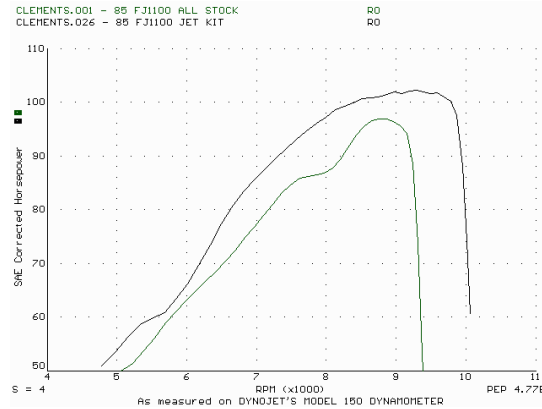

This graph shows a typical gain with a Dynojet jet kit.

WARNING

**NO SMOKING!
 NO OPEN FLAME!
 WHILE INSTALLING
 YOUR DYNOJET KIT**

Parts List

2	Main Jets	DJ110
2	Main Jets	DJ114
2	Fuel Needles	DNT721
2	Adjusting Washers	DW0001
2	E-Clips	DE0001
1	Plug Drill	DD #5/32
1	Screw	DS0001

STAGE ONE INSTRUCTIONS

DYNOJET

E4123.001

Note: It is not necessary to completely remove carburetors from the motorcycle to install this kit.

1. Remove the vacuum slide from the carbs. Remove the stock needles & spacers, noting order of assembly.
2. Install the Dynojet needles on groove #4, using all stock spacers. Install the Dynojet washers above the E-clip.
3. It is not necessary to remove the float bowls to change main jets just remove drain plug. Use a stubby screw driver to loosen the jet and then use a wooden tooth pick to unscrew the jet. Remove the stock main jets and replace with Dynojet main jets provided. If you are running the stock exhaust use the DJ110 main jets, if you are running an after-market header or slip-on with high flowing baffle, use the DJ114 main jets. Be sure that the jets you are changing are the main jets.
4. Locate the Fuel Mixture Plug (Fig. B). Carefully turn mixture screws clockwise until they seat, turn out 1-1/2 turn.

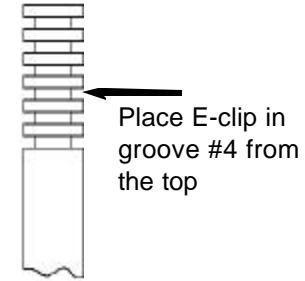

Fig. A

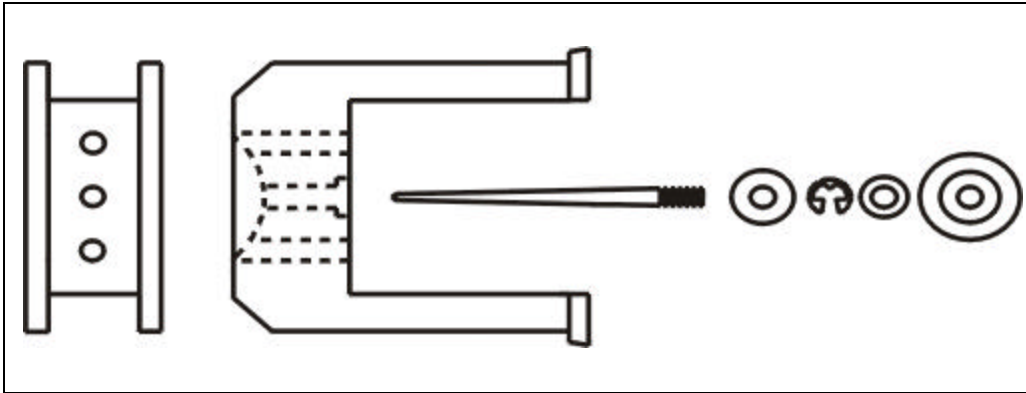

Fig. B

