

Thank you for purchasing this Dynojet kit. This kit has been developed for a motorcycle which is set to the parameters listed at the right in the "Stage" description. If your motorcycle does not meet any of these parameters please check with Dynojet before installation. For technical assistance contact your Dynojet distributor or call Dynojet U.S.A. (800)-992-4993

2191 Mendenhall Dr. Suite 105
 North Las Vegas, NV 89031
 TEL: 702-399-1423
 FAX: 702-399-1431
 8am-5pm Pacific Time
 Monday through Friday

Website Address
<http://www.dynojet.com>

The manufacturer and seller make no warranties express or implied which extend beyond the description of the goods contained herein. Any description of this product is for the purpose of identifying it and shall not be deemed to create an express warranty.



E4140.001

European Models Only

2002 Yamaha XJR1300

Stage 1

For mildly tuned machines using the stock air-box, with stock or K&N filter. May also be used with a good aftermarket exhaust system.
 K&N filter # YA-0082

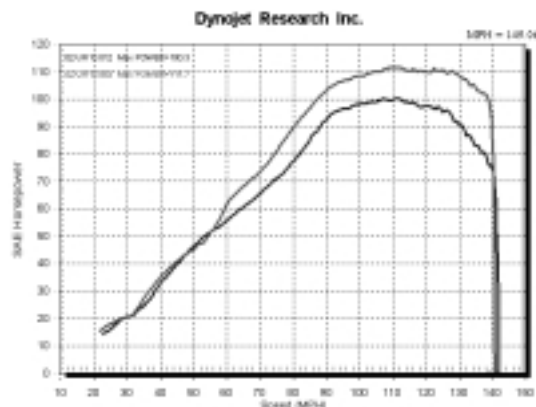

This graph shows a typical gain with a Dynojet jet kit.

WARNING

**NO SMOKING!
 NO OPEN FLAME!
 WHILE INSTALLING
 YOUR DYNOJET KIT**

Parts List

4	Main Jets	DJ094
4	Main Jets	DJ096
4	Main Jets	DJ098
4	Main Jets	DJ100
4	Fuel Needles	DNO712A
4	E-Clips	DE0001
4	Adjusting Washers	DW0001
4	Needle Springs	DSP77
4	Slide Springs	DSP026

STAGE ONE INSTRUCTIONS

1. Remove vacuum slides from carbs. Remove stock needles and spacers, noting order of assembly (Fig.A).
2. Install Dynojet needles on groove #4 from the top. Use all stock spacers (Fig. A). Install the Dynojet slide springs (DSP026) in place of the stock slide springs. The small Dynojet washers are for half step increments and do not have to be installed at this time. **NOTE:** The DSP77 springs do not have to be used, they are supplied in case the stock springs are misplaced. After installing the slides in the carbs be sure to check slide movement manually.
3. Install the Dynojet mains provided. If you are running the stock exhaust install the DJ094 main jets, use the DJ096 main jets with a K&N air filter. If you are running an aftermarket exhaust or slip-on with a high flowing baffle, use the DJ098 main jets, use the DJ100 main jets with a K&N filter. Be sure that the jet you are changing is the main jet.
4. Locate the fuel mixture screw (Fig. B). Carefully turn mixture screws clockwise until lightly seated, then back out 2-1/2 turns or until the best idle is achieved.

DYNOJET

E4140.001

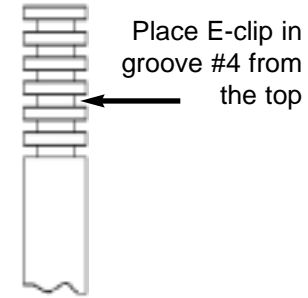

Fig.A

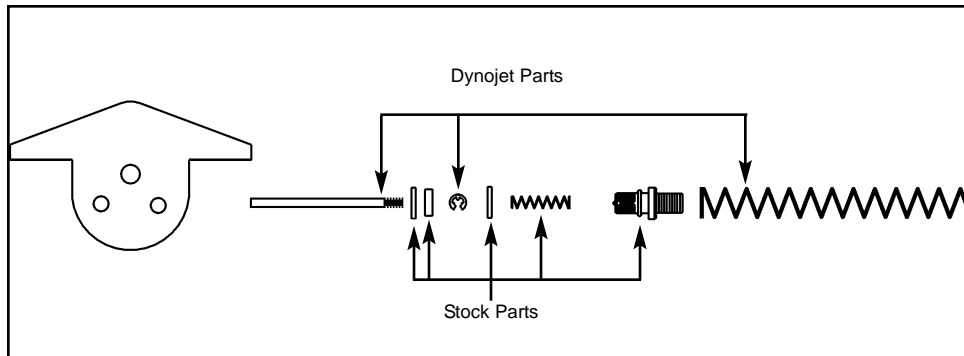

Fig. B
Mixture Screw Location

