

Thank you for purchasing this Dynojet kit. This kit has been developed for a motorcycle which is set to the parameters listed at the right in the "Stage" description. If your motorcycle does not meet any of these parameters please check with Dynojet before installation. For technical assistance contact your Dynojet distributor or call Dynojet U.S.A. (800)-992-4993

2191 Mendenhall Dr. Suite 105  
 North Las Vegas, NV 89031  
 TEL: 702-399-1423  
 FAX: 702-399-1431  
 8am-5pm Pacific Time  
 Monday through Friday

Website Address  
<http://www.dynojet.com>

The manufacturer and seller make no warranties express or implied which extend beyond the description of the goods contained herein. Any description or this product is for the purpose of identifying it and shall not be deemed to create an express warranty.



**E7108.001**

European Models Only

*1997-98 Ducati M900*

**Stage 1**

For mildly tuned machines using the stock airbox with stock or K&N filter. May also be used with a good aftermarket exhaust system  
 K&N filter #DU-0900.

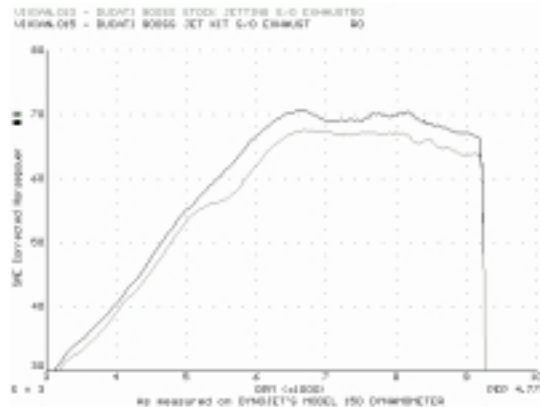

*This graph shows a typical gain with a Dynojet jet kit.*

**WARNING**

**NO SMOKING!  
 NO OPEN FLAME!  
 WHILE INSTALLING  
 YOUR DYNOJET KIT**

<b>Parts List</b>		
2	Main Jets	YJ140
2	Main Jets	YJ144
4	Main Jet O-Rings	YJ-0
2	Slide Springs	DSP007
2	Fuel Needles	DNT730
2	Adjusting Washers	DW0001
2	E-clips	DE0001

## STAGE ONE INSTRUCTIONS

**DYNOJET**

**E7108.001**

1. Remove the vacuum slides from the carbs. Remove the stock needles and spacers, noting the order of assembly (Fig. A).
2. Install the Dynojet needles on groove #3 from the top. Use all stock spacers (Fig. A). Install the small Dynojet washers above the E-clip. After installing the slides in the carbs be sure to check slide movement manually.
3. Install the Dynojet slide springs (DSP007) in place of the stock slide springs, making sure springs are aligned properly. You may use the stock springs for slower throttle response.
4. Remove the stock main jets and install the Dynojet main jets provided. The main jet is a press in jet located next to the large head Mikuni jet. There is a small retaining plate that secures the main jet in place. Remove the large head jets, retaining plates, and then the main jets. Swap the o-rings from the stock main jets to the Dynojet main jets and reinstall all pieces. Use the YJ140 main jets with the stock exhaust, or use the YJ144 main jets with an aftermarket exhaust or slip-on with a high flowing baffle.
5. Locate the fuel mixture screw (Fig. B). Carefully turn mixture screws clockwise until lightly seated, then back out 3-1/2 turns.

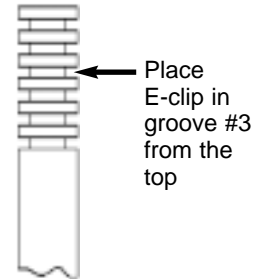

Fig. A

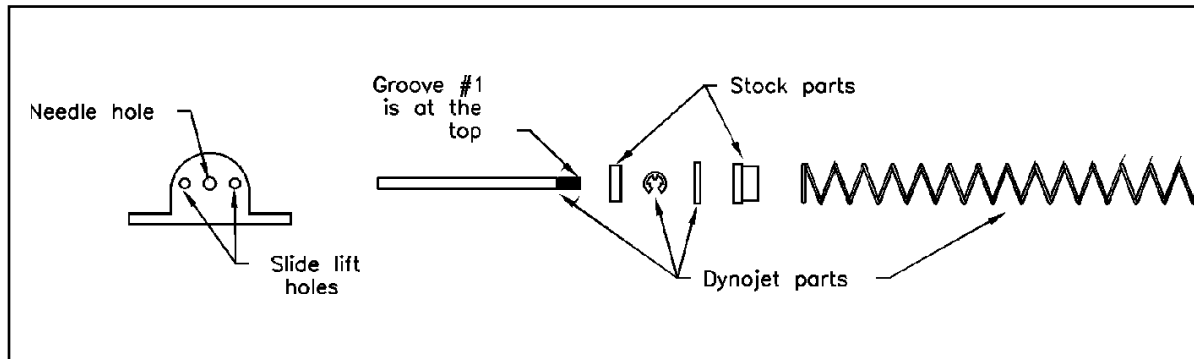

Fig. B

