

Thank you for purchasing this Dynojet kit. This kit has been developed for a motorcycle which is set to the parameters listed at the right in the "Stage" description. If your motorcycle does not meet any of these parameters please check with Dynojet before installation. For technical assistance contact your Dynojet distributor or call Dynojet U.S.A. (800)-992-4993



E8118.001

European Models Only

1999-2002 Buell M2 Cyclone

Keihin CV Carb

For stock or tuned machines using the stock or high flow airbox. May also be used with a good aftermarket exhaust system

2191 Mendenhall Dr. Suite 105
North Las Vegas, NV 89031
TEL: 702-399-1423
FAX: 702-399-1431
8am-5pm Pacific Time
Monday through Friday

Website Address
<http://www.dynojet.com>

The manufacturer and seller make no warranties express or implied which extend beyond the description of the goods contained herein. Any description of this product is for the purpose of identifying it and shall not be deemed to create an express warranty.

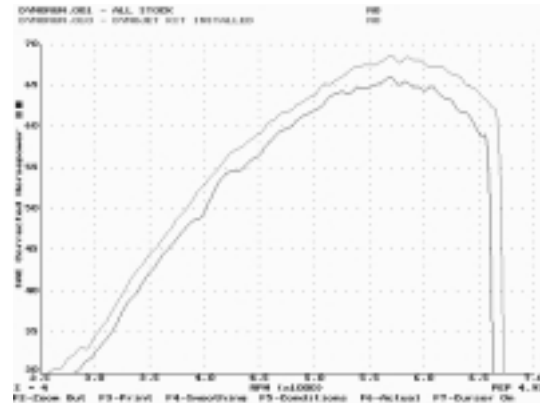

This graph shows a typical gain with a Dynojet jet kit.

WARNING
NO SMOKING!
NO OPEN FLAME!
WHILE INSTALLING
YOUR DYNJET KIT

Parts List		
1	Main Jet	DJ180
1	Main Jet	DJ185
1	Main Jet	DJ190
1	Main Jet	DJ195
1	Main Jet	DJ200
1	Fuel Needle	DNO855
3	Adjusting Washers	DW0001
1	E-Clip	DE0001
1	Slide Spring	DSP009
1	Emulsion Tube	DET001
1	Slide Drill	DD #29
1	Slow Jet	DJSJ045

Stage One Instructions

1. Remove the vacuum slide from the carb. Remove the stock needle & spacers, noting the order of assembly. Locate the slide lift hole using (Fig. A), with the DD# 29 slide drill supplied, enlarge your slide lift hole.
2. Install the Dynojet needle on groove #4. Use all stock spacers (Fig. A). Install the Dynojet washers above the E-clip.
3. Install the Dynojet spring in place of the stock spring, making sure spring is aligned properly.
4. Place the carb upside down on the bench. Remove the float bowl. Remove the stock main jet and remove the emulsion tube (Fig. B), sometimes referred to as the main jet holder. Replace the stock emulsion tube with the Dynojet tube provided. When the Dynojet emulsion tube is fully seated there will still be threads visible. Install the Dynojet main jet provided. Use the DJ185 main jet with a completely stock bike. Use the DJ190 main jet when running an aftermarket exhaust or an aftermarket air box. Use the DJ195 main jet when running an aftermarket exhaust and aftermarket air box.
5. Install the slow jet DJSJ045 provided. Re-install the float bowl.
6. Locate the fuel mixture screw (Fig. B), Carefully turn mixture screw clockwise until seated, turn out 2-1/2 turns if using the stock exhaust and 3 turns out if using an aftermarket exhaust.

DYNOJET

E8118.001

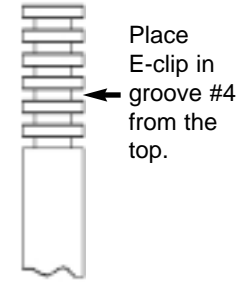

Fig. A

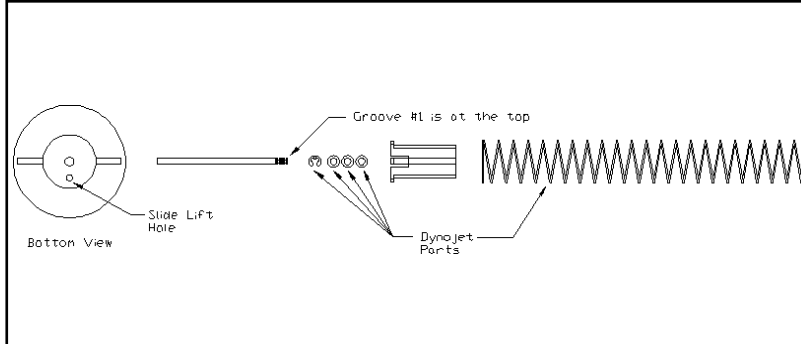

Fig. B

