

[POWER COMMANDER V]

FUEL and IGNITION

2016 Yamaha Wolverine

Installation Instructions



PARTS LIST

- 1 Power Commander
- 1 USB Cable
- 1 Installation Guide
- 2 Power Commander Decals
- 2 Dynojet Decals
- 2 Velcro strips
- 1 Alcohol swab

THE IGNITION MUST BE TURNED OFF BEFORE INSTALLATION!

THE LATEST POWER COMMANDER SOFTWARE AND MAP FILES CAN BE DOWNLOADED FROM OUR WEB SITE AT:
www.powercommander.com

PLEASE READ ALL DIRECTIONS BEFORE STARTING INSTALLATION

Dynojet

2191 Mendenhall Drive North Las Vegas, NV 89081 (800) 992-4993 www.powercommander.com

POWER COMMANDER V INPUT ACCESSORY GUIDE

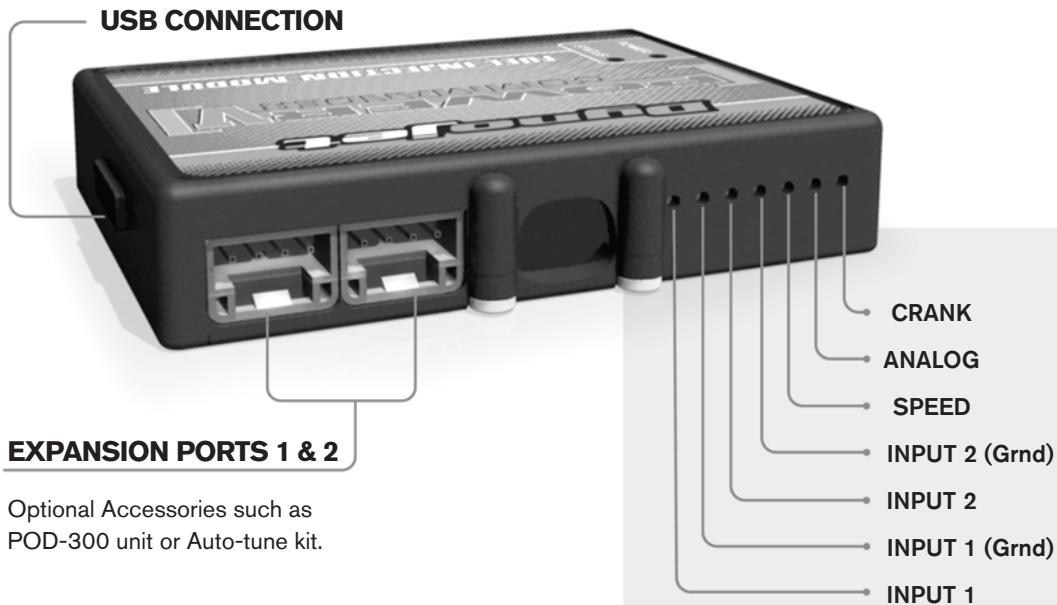

Wire connections:

To input wires into the PCV first remove the rubber plug on the backside of the unit and loosen the screw for the corresponding input. Using a 22-24 gauge wire strip about 10mm from its end. Push the wire into the hole of the PCV until it stops and then tighten the screw. Make sure to reinstall the rubber plug.

NOTE: If you tin the wires with solder it will make inserting them easier.



ACCESSORY INPUTS

Map -

(Input 1 or 2) The PCV has the ability to hold 2 different base maps. You can switch on the fly between these two base maps when you hook up a switch to the MAP inputs. You can use any open/close type switch. The polarity of the wires is not important. When using the Autotune kit one position will hold a base map and the other position will let you activate the learning mode. When the switch is "CLOSED" Autotune will be activated. (Set to Switch Input #1 by default.)

Shifter-

(Input 1 or 2) These inputs are for use with the Dynojet quickshifter. Insert the wires from the Dynojet quickshifter into the SHIFTER inputs. The polarity of the wires is not important. (Set to Switch Input #2 by default.)

Speed-

If your application has a speed sensor then you can tap into the signal side of the sensor and run a wire into this input. This will allow you to calculate gear position in the Control Center Software. Once gear position is setup you can alter your map based on gear position and setup gear dependent kill times when using a quickshifter.

Analog-

This input is for a 0-5v signal such as engine temp, boost, etc. Once this input is established you can alter your fuel curve based on this input in the control center software.

Crank-

Do **NOT** connect anything to this port unless instructed to do so by Dynojet. It is used to transfer crank trigger data from one module to another.

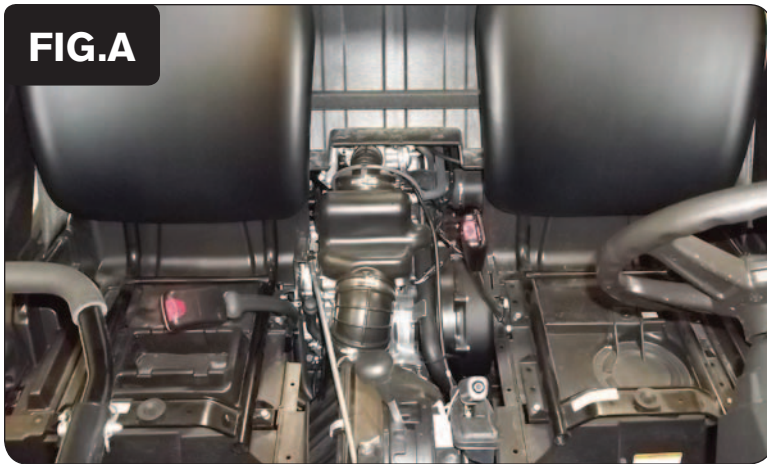

- 1 Remove both seat bottoms, the center storage compartment, and the engine cover/center console (Fig. A).
- 2 Remove the cargo bed.

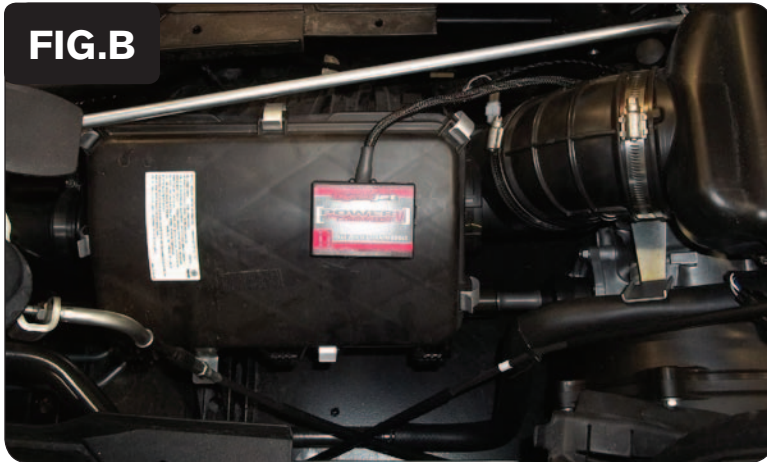

- 3 Use the supplied velcro to secure the PCV module to the top of the airbox (Fig. B).

Use the supplied alcohol swab to clean both surfaces before applying the velcro adhesive.



- 4 Locate and unplug the stock Crank Position Sensor connectors (Fig. C).

This is a WHITE 2-pin connector pair, located on the skid pan, just below the airbox. They are next to two larger GREY connectors.

FIG.D



- 5 Route the pair of WHITE 2-pin connectors with BROWN colored wires on the PCV wiring harness to this location, and plug the PCV in-line of the stock Crank Position Sensor connectors (Fig. D).

FIG.E

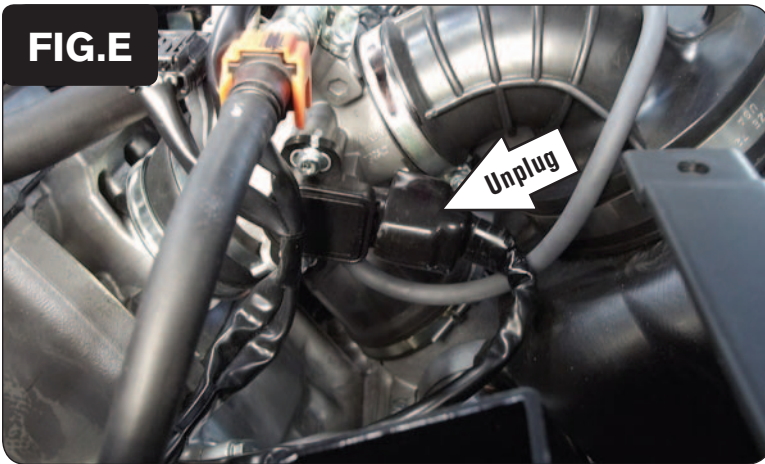

- 6 Locate the Throttle Position Sensor on the right hand side of the throttle body and unplug the stock wiring harness from it (Fig. E).
This is a BLACK 3-pin connector inside of a BLACK rubber boot.

FIG.F



- 7 Plug the pair of 3-pin connectors on the PCV wiring harness in-line of the TPS and stock wiring harness (Fig. F).

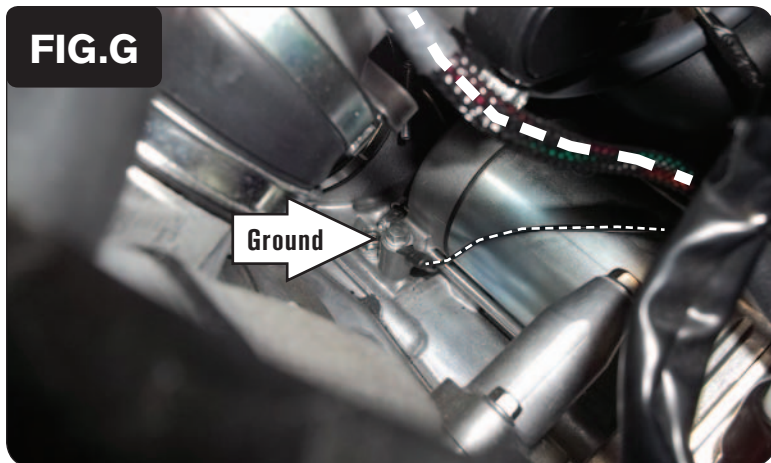

- 8 Secure the PCV ground wire with the small ring terminal to the starter mounting bolt shown in Figure G.

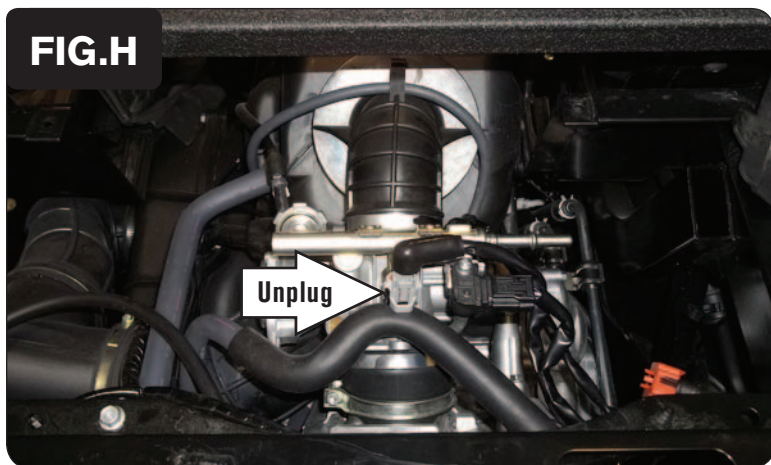

- 9 Unplug the stock wiring harness from the Fuel Injector (Fig. H).
The Fuel Injector is located at the very top of the throttle body. This connector has a BLACK rubber boot covering it.



- 10 Plug the pair of PCV connectors with ORANGE colored wires in-line of the Fuel Injector and the stock wiring harness (Fig. J).

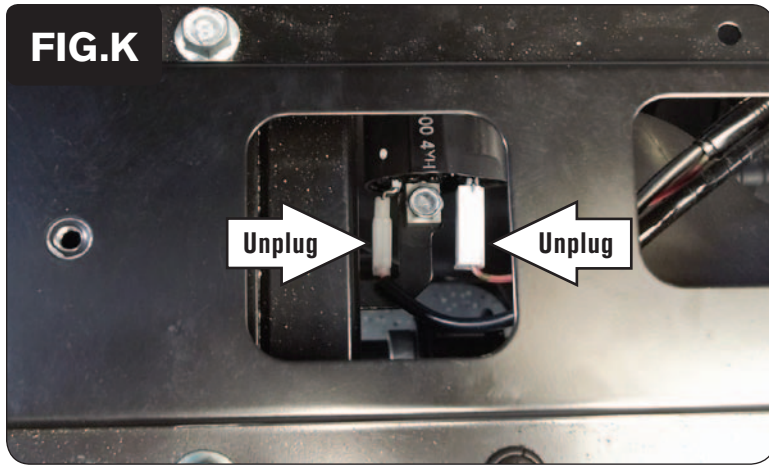

- 11 Locate the Ignition Coil under the frame cross-member and just left of the cylinder head. Unplug both of the stock wires from the Ignition Coil (Fig. K).

There is a stock ORANGE wire on the smaller coil tab, and a stock BROWN/RED wire on the larger coil tab.



- 12 Plug the pair of PCV smaller spade terminals with GREEN colored wires in-line of the smaller coil tab and the stock ORANGE wire.
- 13 Plug the pair of PCV larger spade terminals with RED colored wires in-line of the larger coil tab and the stock BROWN/RED wire (Fig. L).
Make sure to slide the rubber insulators over all of these connection points.
- 14 Reinstall the cargo bed, the engine cover, center compartment, and seats.