

Q103.002
Honda
1992-2001 TRX300 & FW
STAGE 1

*For mildly tuned machines using the stock
airbox, with stock or aftermarket filter. May
also be used with a good aftermarket
exhaust system. K&N Filter # 1992-97
HA-3093, 1998-01 HA-3098 .*

PARTS LIST		
1	Main Jet	DJ116
1	Main Jet	DJ120
1	Main Jet	DJ124
1	Main Jet	DJ128
1	Main Jet	DJ132
1	Fuel Needle	DNO140
1	Slide Drill	DD32
1	Adjusting Washer	DW0001
1	E-Clip	DE0001

STAGE ONE INSTRUCTIONS

1. Remove vacuum slide from carb. Remove stock needle & spacers, noting order of assembly.
2. Drill slide lift hole with DD32 drill bit supplied.
3. Install Dynojet needle on groove# 5 for applications below 6000 feet, groove #4 for above 6000 feet, using all stock spacers. Install the Dynojet washer above the E-clip.
4. Remove stock main jet and replace with Dynojet main provided. Use the DJ124 below 3000 feet, DJ120 from 3000 to 6000 feet and DJ116 above 6000Feet. Be sure that the jet you are changing is the main jet. If you are using the K&N air filter you will need to use a main jet that is 4points larger, ie. if you are using the DJ124 main jet you will need the DJ128.
5. Locate the Fuel Mixture Screw. Using a flat blade screwdriver, turn the mixture screw clockwise until it seats, then turn out 2-1/2 turns .

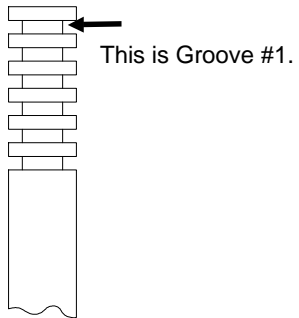

Fig. A

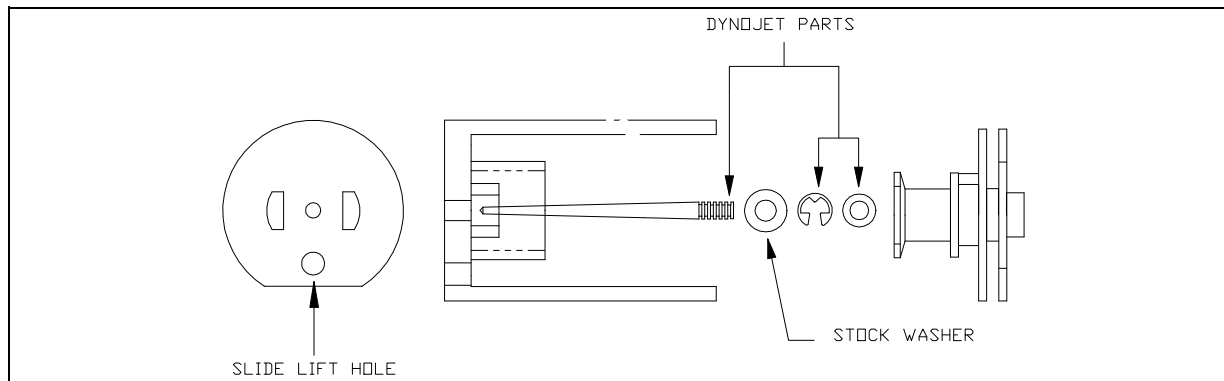

Fig. B

