

Q301.001
1991-2001 SUZUKI LT160

STAGE 2

For mildly tuned machines using the stock airbox, with the lid removed, with stock or aftermarket filter. May also be used with a good aftermarket exhaust system.

K&N Filter # SU-1691

PARTS LIST		
1	Main Jet	DJ092
1	Main Jet	DJ096
1	Main Jet	DJ100
1	Main Jet	DJ104
1	Main Jet	DJ108
1	Fuel Needle	DNO205
1	Adjusting Washer	DW0001
1	E-Clip	DE0001

STAGE TWO INSTRUCTIONS

1. Unscrew the carb top. Disconnect throttle cable and remove the slide. Remove needle retainer.(Fig.A).
2. Install Dynojet needle on groove# 3 for applications below 5000 feet, groove #2 for above 5000 feet, using all stock spacers. Install the Dynojet washer above the E-clip.
3. Remove stock main jet and replace with Dynojet main provided. Use the DJ100 below 3000 feet, DJ096 from 3000 to 6000 feet and DJ092 above 6000Feet. When using an aftermarket exhaust with a high flow baffle, Use the DJ104 below 3000 feet, DJ100 from 3000 to 6000 feet and the DJ096 above 6000 feet. Note: When using the K&N air filter you will need to use a main jet that is 4 points larger. Be sure that the jet you are changing is the main jet.
4. Locate the Fuel Mixture Screw (Fig.B). Using a flat blade screwdriver, turn the mixture screw clockwise until it seats, then turn out 2.5 turns .

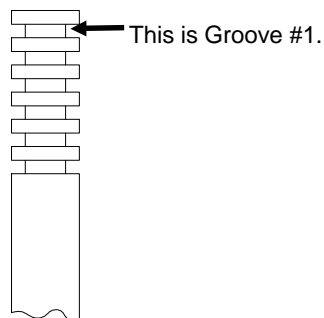

Fig. A

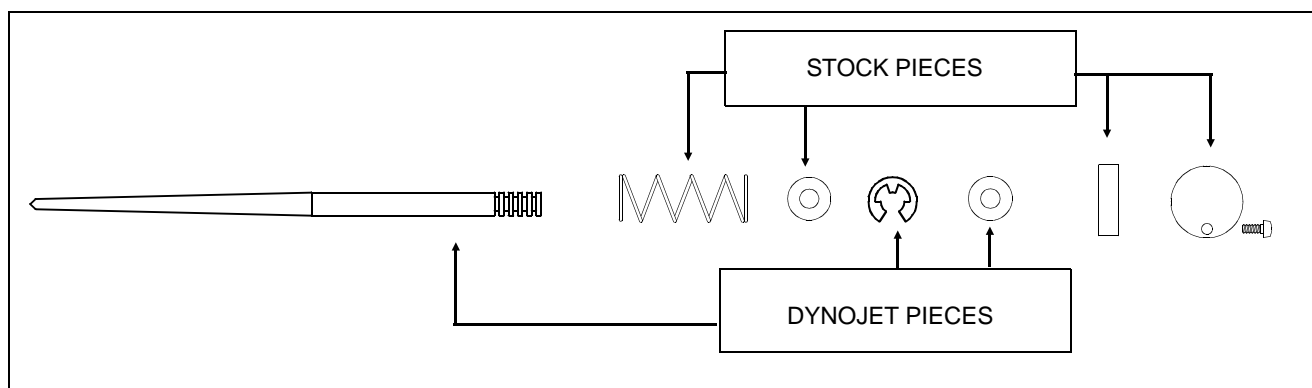

Fig. B

Mixture Screw

