

Q306.001
2000-2001 SUZUKI LTF500
Quad Master

STAGE 1

***For mildly tuned machines using the stock
airbox with stock or aftermarket filter. May
also be used with a good aftermarket
exhaust system. K&N Filter # SU-5098.***

PARTS LIST		
1	Main Jet	DJ116
1	Main Jet	DJ118
1	Main Jet	DJ120
1	Main Jet	DJ122
1	Main Jet	DJ124
1	Main Jet	DJ126
1	Main Jet	DJ128
1	Main Jet	DJ130
1	Fuel Needle	DNO466
1	Adjusting Washer	DW0001
1	E-Clip	DE0001

STAGE ONE INSTRUCTIONS

1. Remove the vacuum slide from the carb. Remove the stock needles & spacers, noting order of assembly (Fig.A).
2. Install the Dynojet needle on groove#3 for applications below 3000 feet, groove #2 for above 3000 feet, using all stock spacers.
3. Remove the stock main jet and replace with the Dynojet main jet provided. If you are running the stock exhaust use the DJ124 below 3000 feet, DJ120 from 3000 to 6000 feet and DJ116 above 6000 feet. If you are using an aftermarket exhaust with a high flow baffle use the DJ128 below 3000 feet, DJ124 from 3000 to 6000 feet and DJ120 above 6000 feet.
4. Locate the Fuel Mixture Screw(Fig. B). Using a flat blade screwdriver, turn the mixture screw clockwise until it seats, then turn out 3 turns if below 3000 feet or 2.5 turns when above 3000 feet.

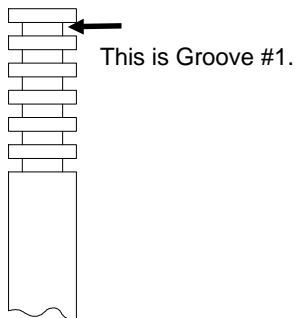

Fig. A

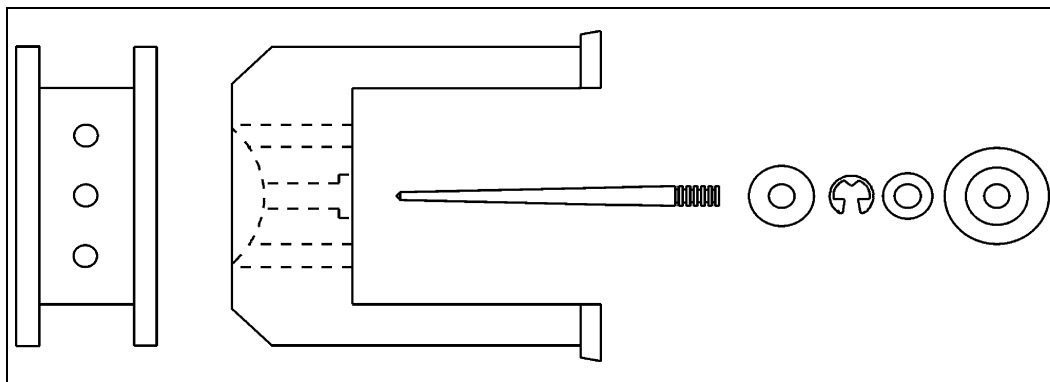

Fig. B

