

Q411.001
1999 Yamaha YFM350FW
Big Bear
STAGE 1

For mildly tuned machines using the stock airbox, with stock or aftermarket filter. May also be used with a good aftermarket exhaust system. K&N Filter# YA-2597.

PARTS LIST		
1	Main Jet	DJ120
1	Main Jet	DJ124
1	Main Jet	DJ128
1	Main Jet	DJ132
1	Main Jet	DJ136
1	Fuel Needle	DNO466
1	Slide Spring	DSP032
1	Adjusting Washer	DW0001
1	E-Clip	DE0001

STAGE ONE INSTRUCTIONS

1. Remove vacuum slide from the carb. Remove stock needles & spacers, noting order of assembly (Fig.A).
2. Install Dynojet needle on groove#3 for applications below 5000 feet, groove #2 for above 5000 feet, using all stock spacers. Install the Dynojet slide spring DSP032.
3. Remove stock main jet and replace with Dynojet main provided. If you are running the stock exhaust use the DJ128 below 3000 feet, DJ124 from 3000 to 6000 feet and DJ120 above 6000 feet. If you are running an aftermarket exhaust with a high flow baffle use the DJ132 below 3000 feet, DJ128 from 3000 to 6000 feet and the DJ124 above 6000 feet.
4. Locate the Fuel Mixture Screw(Fig. B). Using a flat blade screwdriver, turn the mixture screw clockwise until it seats, then turn out 3 1/2 turns.

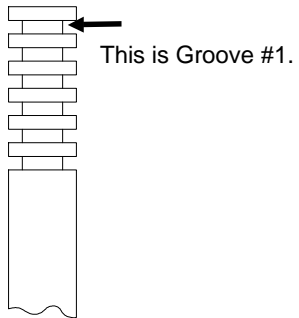

Fig. A

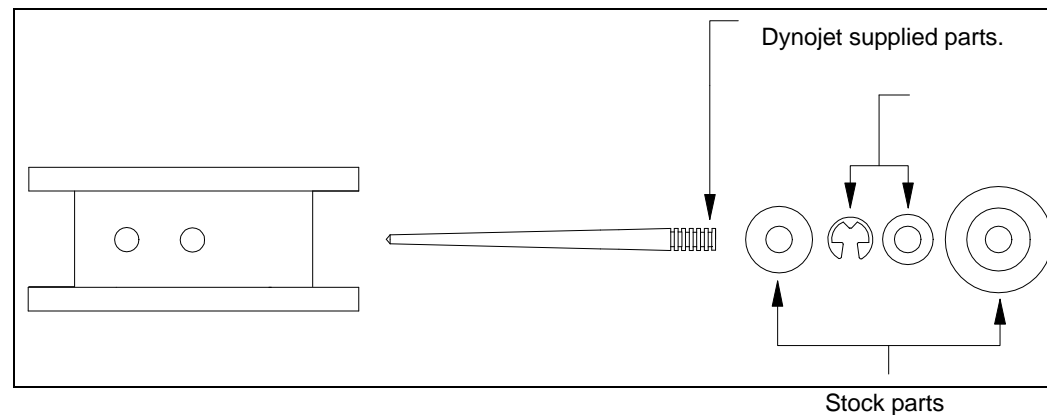

Fig. B

