

**Q437.001**  
**2012-2013 Yamaha**  
**300 Grizzly**  
**Stage 1**

For mildly tuned machines using the stock airbox with stock or aftermarket filter. May also be used with a good aftermarket exhaust system.

<b><i>Parts List</i></b>		
1	Main Jet	DJ118
1	Main Jet	DJ122
1	Main Jet	DJ126
1	Main Jet	DJ130
1	Main Jet	DJ134
1	Fuel Needle	DNO368
2	Adjusting Washers	DW0001
1	E-Clip	DE0001
1	Drill	DD #37
1	Screw	DS0001

## STAGE ONE INSTRUCTIONS

Q437.001

1. Remove vacuum slide from carb. Remove stock needle & spacers, noting order of assembly (Fig.A).
2. Locate the slide lift hole in Fig. A. Enlarge the slide lift hole with the drill provided (DD #37).
3. Install Dynojet needle on groove #4 for applications below 5000 feet, groove #3 for above 5000 feet, using all stock spacers. Install the Dynojet washers above the E-clip (Fig.A).
4. Remove stock main jet and replace with Dynojet main jet provided. With the stock exhaust, use the DJ126 below 3000 feet, DJ122 from 3000 to 6000 feet and DJ118 above 6000 feet. When using an aftermarket exhaust with a high flow baffle, use the DJ130 below 3000 feet, DJ126 from 3000 to 6000 feet and the DJ122 above 6000 feet.
5. Locate the Fuel Mixture Screw (Fig.B). If you see a screw head at Fig.B then proceed to the adjusting procedure. With the #37 drill bit provided carefully drill through the plug. **NOTE: The mixture screw is directly underneath this plug, be ready to pull back on the drill the instant you break through.** Use the screw provided to secure and remove this plug. Carefully turn the mixture screw clockwise until lightly seated, then turn out 3.5 turns, 2 turns above 5000 feet.

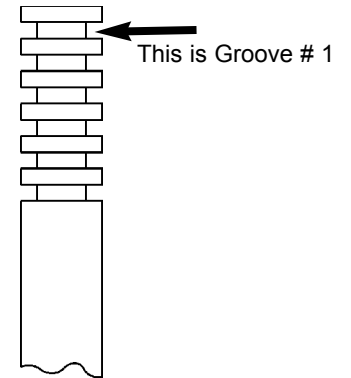

Fig.A

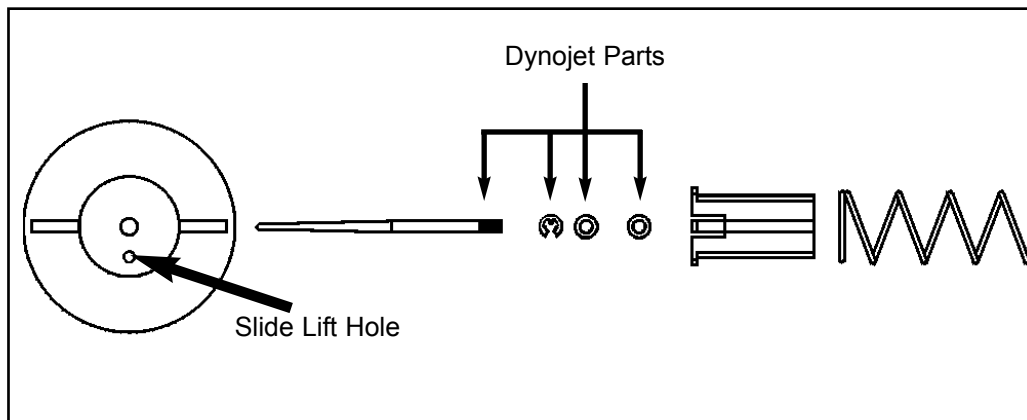

Fig.B

