

Q517.001
2003-2005 Polaris
Magnum 330
Stage 1

For mildly tuned machines using the stock airbox with stock or aftermarket filter. May also be used with a good aftermarket exhaust system.

<i>Parts List</i>		
1	Main Jet	DJ108
1	Main Jet	DJ112
1	Main Jet	DJ116
1	Main Jet	DJ120
1	Main Jet	DJ124
1	Main Jet	DJ128
1	Fuel Needle	DNO240
1	Adjusting Washer	DW0001
1	E-Clip	DE0001
1	Plug Drill	DD 5/32
1	Screw	DS0001

STAGE ONE INSTRUCTIONS

Q517.001

1. Remove vacuum slide from the carb. Remove stock needle & spacers, noting order of assembly (Fig. A).
2. Install Dynojet needle on groove #2 from the top, groove #1 above 5000 feet, using all stock spacers. Install the Dynojet washer above the E-clip.
3. Remove stock main jet and replace with Dynojet main jet provided. If you are running the stock exhaust, use the DJ120 below 3000 feet, DJ116 from 3000 to 6000 feet and DJ112 above 6000 feet. If you are running an aftermarket exhaust, use the DJ124 below 3000 feet, DJ120 from 3000 to 6000 feet and DJ116 above 6000 feet. Be sure that the jet you are changing is the main jet.
4. Locate the Fuel Mixture Screw (Fig.B). If you see a screw head at Fig. B then proceed to the adjusting procedure. With the 5/32 drill bit provided carefully drill through the plug. **NOTE: The mixture screw is directly underneath this plug, be ready to pull back on the drill the instant you break through.** Use the screw provided to secure and remove this plug. Using a flat blade screwdriver, turn the mixture screw clockwise until it seats, then turn out 3 turns below 5000 feet or 2.5 turns above 5000 feet.

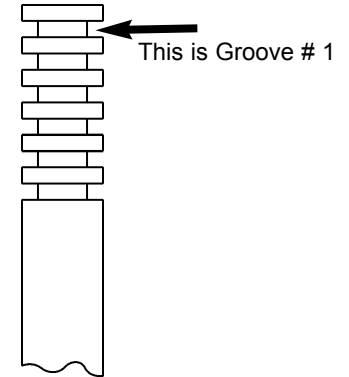

Fig.A

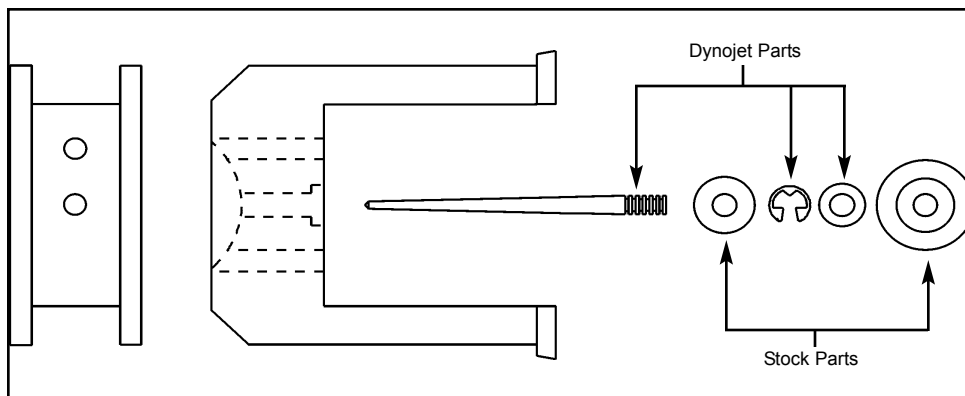

Fig.B

