

Q523.001

2006-2007 Polaris

500 Outlaw

Stage 1,2&3

Stage1

For mildly tuned machines using the stock airbox with stock or stock replacement filter. May also be used with a good aftermarket exhaust system.

Stage2

For mildly tuned machines using the stock airbox with the lid removed and a stock or stock replacement filter. May also be used with a good aftermarket exhaust system.

Stage3

For mildly tuned machines with the stock airbox removed, using a K&N aftermarket filter. Should also be used with a good aftermarket exhaust system. K&N Filter # RU-0810

<i>Parts List</i>		
1	Main Jet	DJ142
1	Main Jet	DJ146
1	Main Jet	DJ150
1	Main Jet	DJ155
1	Main Jet	DJ160
1	Main Jet	DJ165
1	Main Jet	DJ170
1	Main Jet	DJ175
1	Main Jet	DJ180
1	Fuel Needle	DNO711
1	Needle Spring	DSP77
1	Adjusting Washer	DW0001
1	E-Clip	DE0001
1	Plug Drill	DD 5/32
1	Screw	DS0001

STAGE ONE INSTRUCTIONS

1. Remove vacuum slide from carb. Remove stock needle & spacers, noting order of assembly (Fig.A).
2. Install Dynojet needle on groove #3, using all stock spacers (Fig.A). **NOTE:** The DSP77 spring does not have to be used, it is supplied in case the stock spring is misplaced. The Dynojet washer (DW0001) does not need to be installed at this time, it is for half step adjustments. After installing the slides in the carbs be sure to check slide movement manually before air box installation.
3. Remove stock main jet and replace with Dynojet main jet provided. Use the DJ150 below 3000 feet, DJ146 from 3000 to 6000 feet and DJ142 above 6000 feet. When using an aftermarket exhaust with a high flow baffle, Use the DJ155 below 3000 feet, DJ150 from 3000 to 6000 feet and the DJ146 above 6000 feet.
4. Locate the fuel mixture plug (Fig. B). If you see a screw head at Fig. B then proceed to the adjusting procedure. With the 5/32 drill bit provided carefully drill through the plug. **NOTE:** The mixture screw is directly underneath this plug, be ready to pull back on the drill the instant you break through. Use screw provided to secure and remove this plug. Carefully turn the mixture screws clockwise until lightly seated, then back out 3 turns, 2.5 turns above 5000 feet.

STAGE TWO INSTRUCTIONS

1. Remove the airbox lid.
2. Remove vacuum slide from carb. Remove stock needle & spacers, noting order of assembly (Fig.A).
3. Install Dynojet needle on groove #3 from the top, using all stock spacers (Fig.A). **NOTE:** The DSP77 spring does not have to be used, it is supplied in case the stock spring is misplaced. The Dynojet washer (DW0001) does not need to be installed at this time, it is for half step adjustments. After installing the slides in the carbs be sure to check slide movement manually before air box installation.
4. Remove stock main jet and replace with Dynojet main jet provided. Use the DJ160 below 3000 feet, DJ155 from 3000 to 6000 feet and DJ150 above 6000 feet. When using an aftermarket exhaust with a high flow baffle, Use the DJ165 below 3000 feet, DJ160 from 3000 to 6000 feet and the DJ155 above 6000 feet.
5. Locate the fuel mixture plug (Fig. B). If you see a screw head at Fig. B then proceed to the adjusting procedure. With the 5/32 drill bit provided carefully drill through the plug. **NOTE:** The mixture screw is directly underneath this plug, be ready to pull back on the drill the instant you break through. Use screw provided to secure and remove this plug. Carefully turn the mixture screws clockwise until lightly seated, then back out 3 turns, 2.5 turns above 5000 feet.

STAGE THREE INSTRUCTIONS

1. Remove the airbox and use K&N air filter RU-0810.
2. Remove vacuum slide from carb. Remove stock needle & spacers, noting order of assembly (Fig.A).
3. Install Dynojet needle on groove #3 from the top, using all stock spacers (Fig.A). **NOTE:** The DSP77 spring does not have to be used, it is supplied in case the stock spring is misplaced. The Dynojet washer (DW0001) does not need to be installed at this time, it is for half step adjustments. After installing the slides in the carbs be sure to check slide movement manually before air box installation.
4. Remove stock main jet and replace with Dynojet main jet provided. Use the DJ170 below 3000 feet, DJ165 from 3000 to 6000 feet and DJ160 above 6000 feet. When using an aftermarket exhaust with a high flow baffle, Use the DJ175 below 3000 feet, DJ170 from 3000 to 6000 feet and the DJ165 above 6000 feet.
5. Locate the fuel mixture plug (Fig. B). If you see a screw head at Fig. B then proceed to the adjusting procedure. With the 5/32 drill bit provided carefully drill through the plug. **NOTE:** The mixture screw is directly underneath this plug, be ready to pull back on the drill the instant you break through. Use screw provided to secure and remove this plug. Carefully turn the mixture screws clockwise until lightly seated, then back out 3 turns, 2.5 turns above 5000 feet.

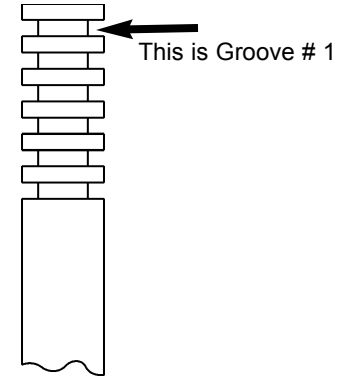

Fig.A

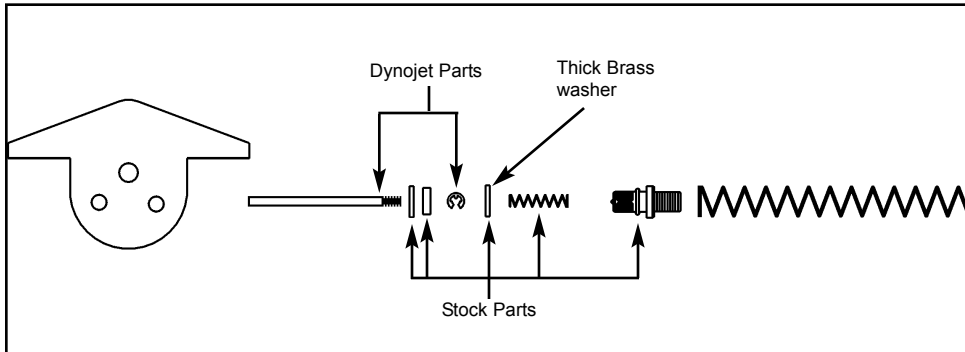
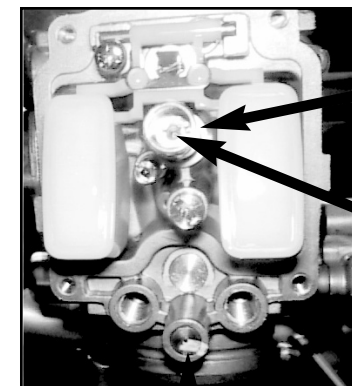

Fig.B



Main Jet cup must be re-installed

Main Jet

Mixture Screw Location