

# Q713.001

## 2004-2007 Bombardier Rally 200

### Stage 1

For mildly tuned machines using the stock airbox with stock or aftermarket filter. May also be used with a good aftermarket exhaust system.

<b><i>Parts List</i></b>		
1	Main Jet	DJ094
1	Main Jet	DJ098
1	Main Jet	DJ102
1	Main Jet	DJ106
1	Fuel Needle	DNO185
1	Adjusting Washer	DW0001
1	E-Clip	DE0001

## STAGE ONE INSTRUCTIONS

1. Unscrew top carb plate. Disconnect throttle cable and remove slide (Fig. A).
2. Install Dynojet needle on groove #4 for applications below 5000 feet, groove #3 for above 5000 feet, using all stock spacers. Install the Dynojet washer above the E-clip.
3. Remove stock main jet, discard the main jet cup it will not be reused. When using the stock exhaust use the DJ102 below 3000 feet, DJ098 from 3000 to 6000 feet and DJ094 above 6000 feet. When using an aftermarket exhaust use the DJ106 below 3000 feet, DJ102 from 3000 to 6000 feet and DJ098 above 6000 feet. Be sure that the jet you are changing is the main jet.
4. Locate the Fuel Mixture Screw (Fig. B). Using a flat blade screwdriver, turn the mixture screw clockwise until it seats, then turn out 1.5 turn below 5000 feet or 1 above 5000 feet.

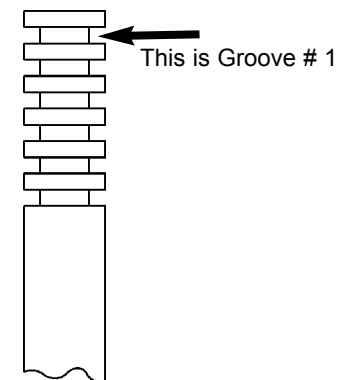

Fig.A

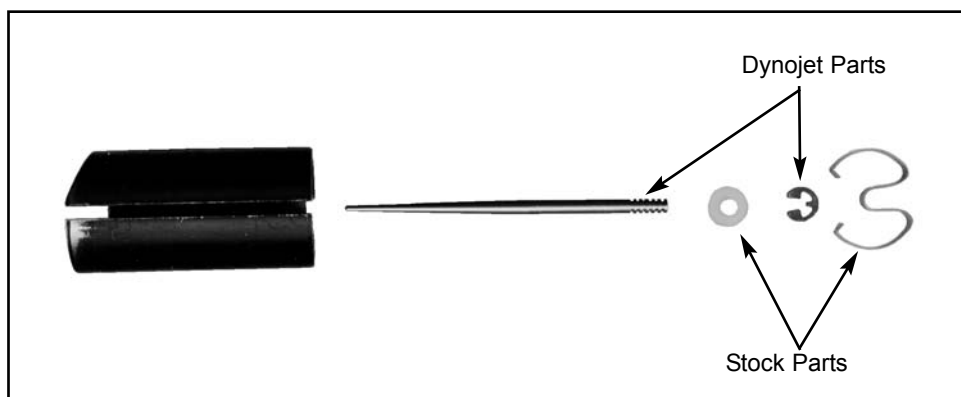

Fig.B

