

Thank you for purchasing this Dynojet kit. This kit has been developed for a motorcycle which is set to the parameters listed at the right in the "Stage" description. If your motorcycle does not meet any of these parameters please check with Dynojet before installation. For technical assistance contact your Dynojet distributor or call Dynojet U.S.A. (800)-992-4993



E7204.001

European Models Only

1994-98 Ducati M600 & SS

Stage 2

For mildly tuned machines using the stock airbox with the lid removed and K&N filter. May also be used with a good aftermarket exhaust system K&N filter #DU-0900.

2191 Mendenhall Dr. Suite 105
 North Las Vegas, NV 89031
 TEL: 702-399-1423
 FAX: 702-399-1431
 8am-5pm Pacific Time
 Monday through Friday

Website Address
<http://www.dynojet.com>

The manufacturer and seller make no warranties express or implied which extend beyond the description of the goods contained herein. Any description or this product is for the purpose of identifying it and shall not be deemed to create an express warranty.

WARNING

**NO SMOKING!
 NO OPEN FLAME!
 WHILE INSTALLING
 YOUR DYNOJET KIT**

Parts List

2	Main Jets	YJ144
2	Main Jets	YJ148
4	Main Jet O-Rings	YJ-0
2	Slide Springs	DSP007
2	Fuel Needles	DNT729
2	Adjusting Washers	DW0001
2	E-Clips	DE0001

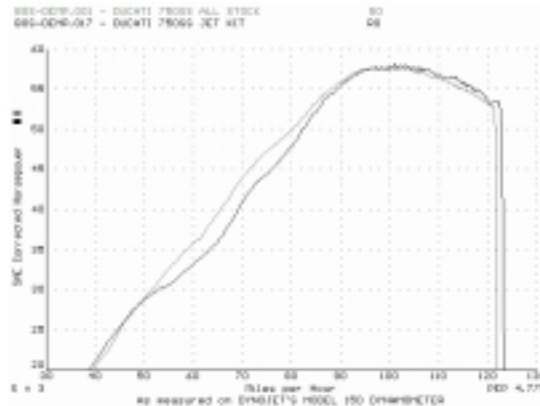

This graph shows a typical gain with a Dynojet jet kit.

STAGE TWO INSTRUCTIONS

DYNOJET

E7204.001

1. Remove the vacuum slides from the carbs. Remove the stock needles and spacers, noting the order of assembly (Fig. A).
2. Install the Dynojet needles on groove #4 from the top. Use all stock spacers (Fig. A). Install the small Dynojet washers above the E-clip.
3. Install the Dynojet slide springs (DSP007) in place of the stock springs, making sure springs are aligned properly. You may use the stock springs for slower throttle response.
4. Remove the stock main jets and install the Dynojet main jets provided. The main jet is a press in jet located next to the large head Mikuni jet. There is a small retaining plate that secures the main jet in place. Remove the large head jet, retaining plate, and then the main jet. Swap the o-ring from the stock main jet to the Dynojet main jet and reinstall all pieces. Use the YJ144 main jets with the stock exhaust, or use the YJ148 main jets with an aftermarket exhaust or slip-on with a high flowing baffle.
5. Locate the fuel mixture screw (Fig. B). Carefully turn the mixture screws clockwise until lightly seated, then back out 2-1/2 turns.

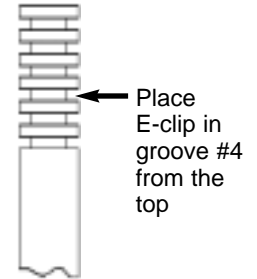

Fig. A

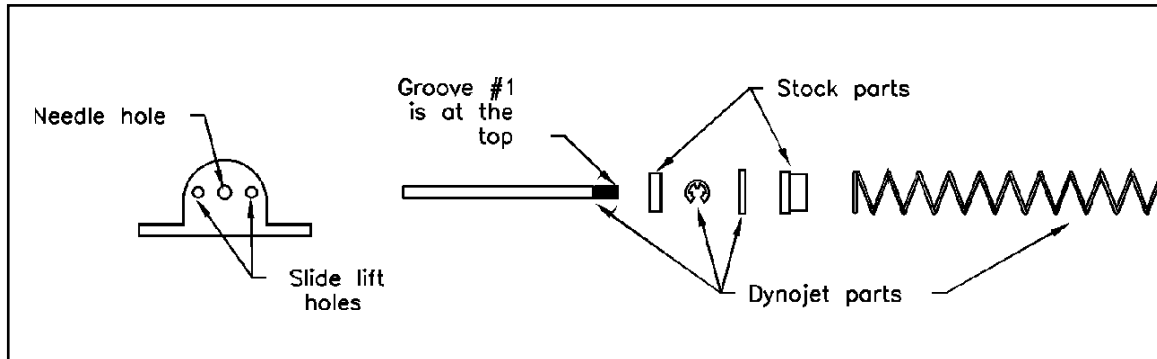

Fig. B

